



UNIVERSITAS NEGERI YOGYAKARTA
FAKULTAS ILMU PENDIDIKAN

BUKU PRASARANA



SUB BAGIAN
UKBMN

2021
DESEMBER

KATA PENGANTAR

30 Desember 2021
Dekan,

Dr. Sujarwo, M.Pd.

DAFTAR ISI

- 1 KAMPUS 1 KARANGMALANG
- 2 B.01 GD. ABDULLAH SIGIT A LT. 1
- 3 B.01 GD. ABDULLAH SIGIT A LT. 2
- 4 B.01 GD. ABDULLAH SIGIT A LT. 3
- 5 B.02 GD. ABDULLAH SIGIT B LT. 1
- 6 B.02 GD. ABDULLAH SIGIT B LT. 2
- 7 B.03 GD. ABDULLAH SIGIT C LT. 1
- 8 B.03 GD. ABDULLAH SIGIT C LT. 2
- 9 B.04 GD. ABDULLAH SIGIT D LT. 1
- 10 B.04 GD. ABDULLAH SIGIT D LT. 2
- 11 B.05 GUDANG
- 12 B.06. GEDUNG ORMAWA LT. 1
- 13 B.06. GEDUNG ORMAWA LT. 2
- 14 B.05 GD. NOENG MUHAJIR LT. 1
- 15 B.05 GD. NOENG MUHAJIR LT. 2
- 16 B.05 GD. NOENG MUHAJIR LT. 3
- 17 B.28 GD. DAKIR BASEMENT
- 18 B.28 GD. DAKIR LT. 1
- 19 B.28 GD. DAKIR LT. 2
- 20 B.28 GD. DAKIR LT. 3
- 21 B.30 GD. MOH AMIN BASEMENT
- 22 B.30 GD. MOH AMIN LT. 1
- 23 B.30 GD. MOH AMIN LT. 2
- 24 B.30 GD. MOH AMIN LT. 3
- 25 B.31 GD. MOH AMIN BASEMENT
- 26 B.31 GD. MOH AMIN LT. 1
- 27 B.31 GD. MOH AMIN LT. 2
- 28 B.31 GD. MOH AMIN LT. 3
- 29 B.14 ASRAMA KAMPUS 2 LT.1
- 30 B.14 ASRAMA KAMPUS 2 LT.2
- 31 ASRAMA CONDRONEGARAN
- 32 B.20 MUSHOLA ASRAMA
- 33 B.23 ASRAMA SAYAP TIMUR
- 34 B.22 ASRAMA SAYAP BARAT
- 35 B.25 ASRAMA TENGAH
- 36 KAMPUS 3 JALAN BANTUL
- 37 B.15 GD KULIAH 51-53
- 38 B.16 GD. LAB IPA & KOMPUTER
- 39 B.17 TK PEDAGOGIA
- 40 B.18 GD PENDOPO & TU
- 41 B.19 LAB. MICRO & UKM
- 42 B.21 GD. KULIAH KAMPUS 3
- 43 B.24 GD. KULIAH KAMPUS 3
- 44 B.26 GD. KULIAH KAMPUS 3
- 45 B.29 GD. KULIAH KAMPUS 3
- 46 KAMPUS II JALAN KENARI
- 47 B.08 GD KULIAH 41-43
- 48 B.09 GD KULIAH & MUSHOLA
- 49 B.07 GD KULIAH 38-40
- 50 B.11 AULA KAMPUS 2
- 51 B.10 GD KULIAH 42-43
- 52 B.12 GD KULIAH & PERPUSTAKAAN

KAMPUS 1 KARANGMALANG

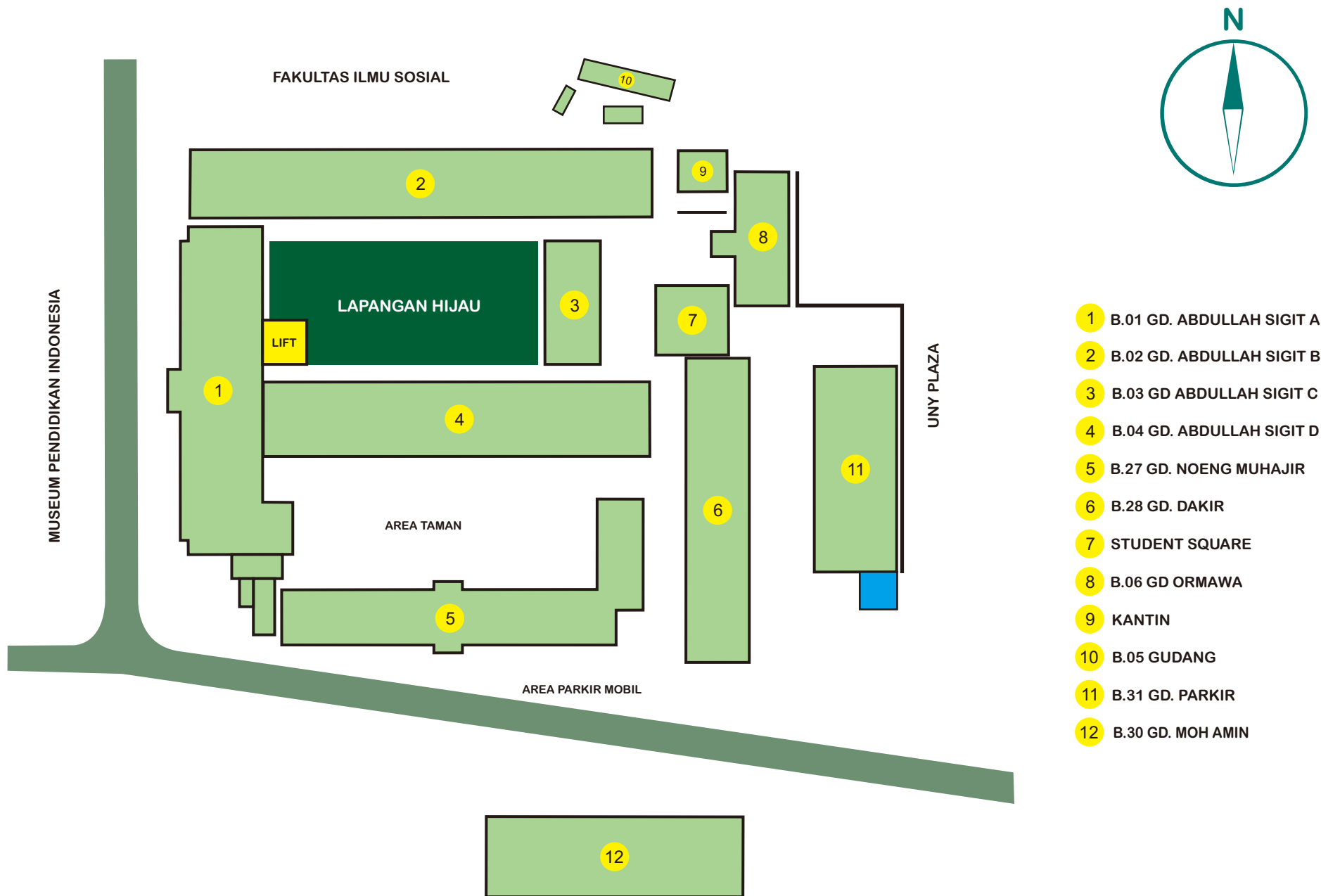

B.01 ABDULLAH SIGIT A LT. 1

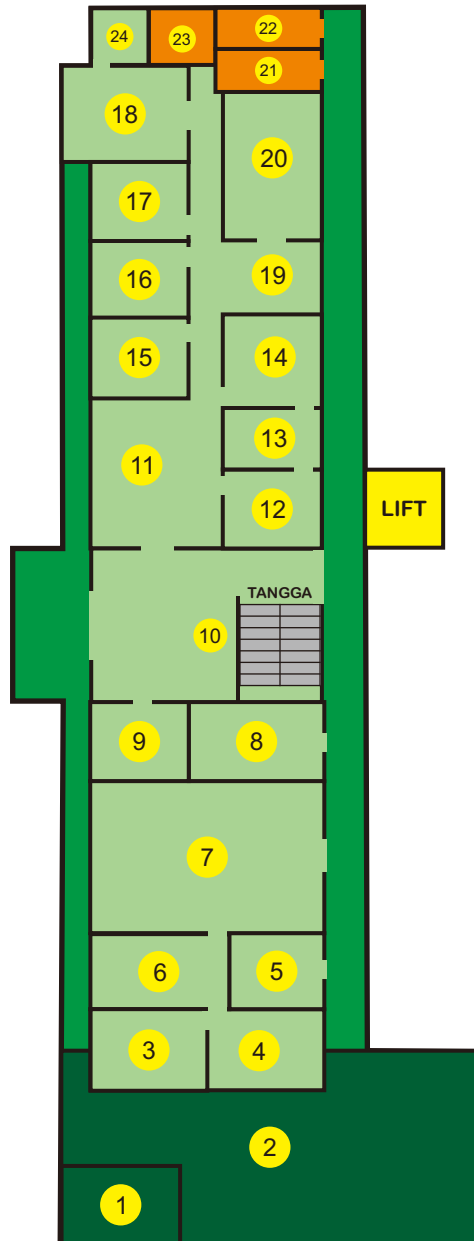

KETERANGAN

- | | |
|-----------------------------------|--|
| 1 B.01.1.22 RUANG TAKMIR | 13 B.01.1.12 RUANG KEPEGAWAIAN |
| 2 B.01.1.01 MUSHOLA AL-QOLAM | 14 B.01.1.10 RUANG KOORDINATOR TU |
| 3 B.01.1.02 RUANG ARSIP AKA | 15 B.01.1.15 RUANG WAKIL DEKAN BIDANG KEMAHASISWAAN DAN ALUMNI |
| 4 B.01.1.03 GUDANG SUBBAG AKA | 16 B.01.1.13 RUANG WAKIL DEKAN BIDANG UMUM DAN KEUANGAN |
| 5 B.01.1.04 LAYANAN KEMAHASISWAAN | 17 B.01.1.14 RUANG WAKIL DEKAN BIDANG AKADEMIK DAN KERJASAMA |
| 6 B.01.1.05 RUANG PENGGANDAAN | 18 B.01.1.16 RUANG SIDANG DEKANAT |
| 7 B.01.1.06 SUBBAG AKA | 19 B.01.1.19 RUANG SEKRETARIS PIMPINAN |
| 8 B.01.1.07 RUANG UJIAN SKRIPSI A | 20 B.01.1.18 RUANG DEKAN |
| 9 B.01.1.08 RUANG HUMAS | 21 B.01.1.20 TOILET DISABILITAS PUTRI |
| 10 B.01.1.09 LOBBY DEKANAT | 22 B.01.1.21 TOILET DISABILITAS PUTRA |
| 11 B.01.1.11 RUANG TATA USAHA | 23 B.01.1.17 TOILET DEKANAT |
| 12 B.01.1.23 RUANG SERVER | 24 B.01.1.24 RUANG LAKTASI |

B.01 ABDULLAH SIGIT A LT. 2

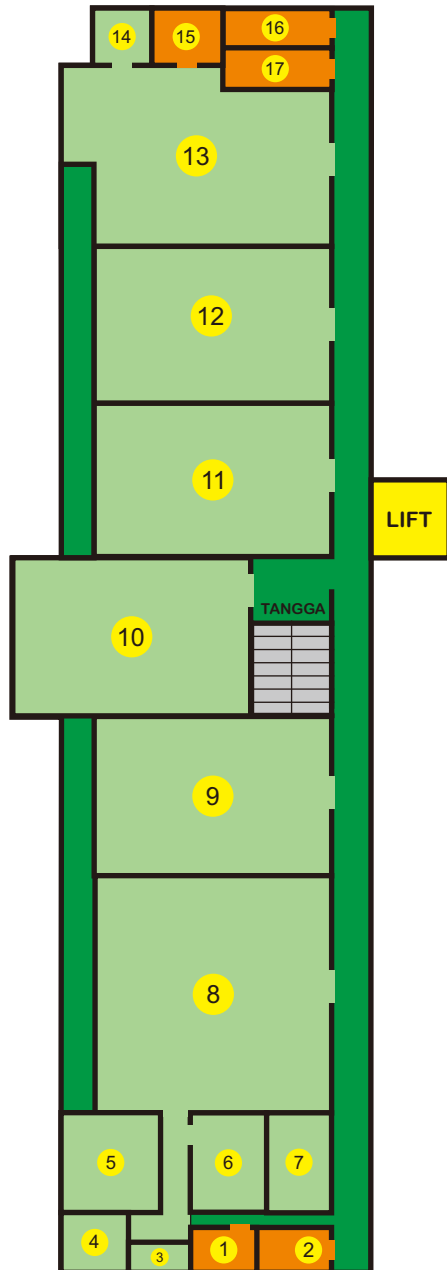

KETERANGAN

- | | | | |
|---|-------------------------------|----|-----------------------------------|
| 1 | B.01.2.01 TOILET PUTRA | 9 | B.01.2.04 RUANG BACA |
| 2 | B.01.2.02 TOILET PUTRI | 10 | B.01.2.16 RUANG PENJAMINAN MUTU |
| 3 | B.01.2.11 TOILET PERPUSTAKAAN | 11 | B.01.2.05 LAB. KOMPUTER FAKULTAS |
| 4 | B.01.2.12 RUANG IBADAH | 12 | B.01.2.06 RUANG JURUSAN PSIKOLOGI |
| 5 | B.01.2.13 RUANG TANDON | 13 | B.01.2.07 RUANG JURUSAN AP |
| 6 | B.01.2.14 RUANG STAF ADMIN | 14 | B.01.2.17 RUANG IBADAH |
| 7 | B.01.2.15 GUDANG | 15 | B.01.2.08 TOILET JURUSAN AP |
| 8 | B.01.2.03 RUANG SIRKULASI | 16 | B.01.2.09 TOILET PUTRA |
| | | 17 | B.01.2.10 TOILET PUTRI |

B.01 ABDULLAH SIGIT A LT. 3

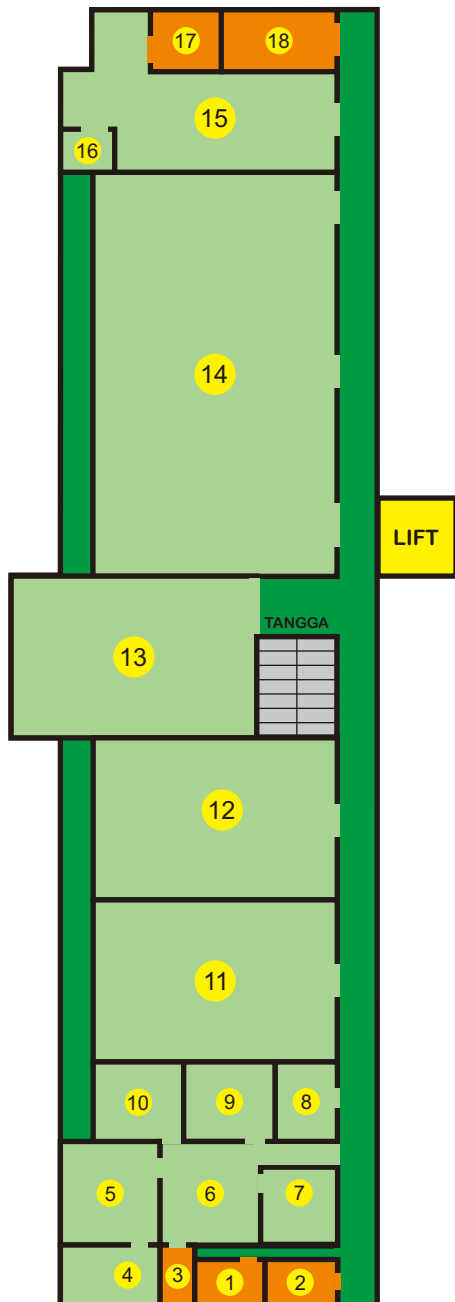

KETERANGAN

- | | | | |
|---|----------------------------------|----|---------------------------------------|
| 1 | B.01.3.01 TOILET PUTRA | 10 | B.01.3.05 R. KONSELING & AUDIO VISUAL |
| 2 | B.01.3.02 TOILET PUTRI | 11 | B.01.3.07 RUANG KULIAH 3 |
| 3 | B.01.3.17 TOILET PSIKOLOGI | 12 | B.01.3.08 RUANG KULIAH 4 |
| 4 | B.01.3.03 RUANG KEPALA LAB | 13 | B.01.3.18 STUDENT SQUARE |
| 5 | B.01.3.04 RUANG DISKUSI | 14 | B.01.3.09 HALL ABDULLAH SIGIT |
| 6 | B.01.3.14 RUANG ASISTEN LAB | 15 | B.01.3.10 RUANG TRANSIT |
| 7 | B.01.3.15 RUANG PSIKODIAGNOSTIKA | 16 | B.01.3.13 RUANG OPERATOR |
| 8 | B.01.3.16 GUDANG | 17 | B.01.3.11 TOILET DALAM |
| 9 | B.01.3.06 RUANG OBSERVASI | 18 | B.01.3.12 TOILET LUAR |

B.02 ABDULLAH SIGIT B LT. 1

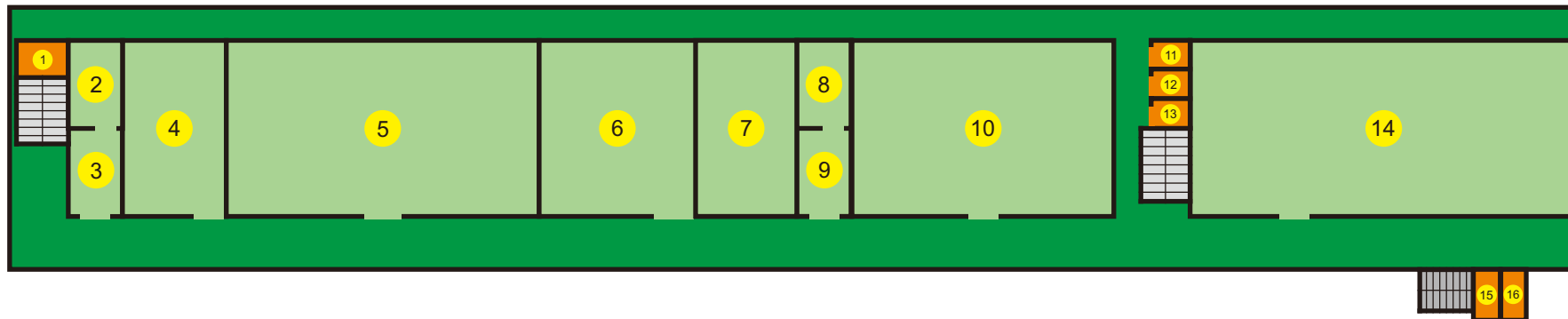

KETERANGAN

- | | | |
|---------------------------------|--------------------------------|-------------------------------|
| 1 B.02.1.01 TOILET | 6 B.02.1.09 LAB. PLS | 11 B.02.1.16 TOILET |
| 2 B.02.1.02 RUANG SERVER | 7 B.02.1.10 LAB. PLS | 12 B.02.1.17 TOILET |
| 3 B.02.1.03 RUANG ARSIP | 8 B.02.1.12 GUDANG | 13 B.02.1.18 TOILET |
| 4 B.02.1.04 R. SUBBAG KEU & AKA | 9 B.02.1.16 RUANG UKS | 14 B.02.1.19 LAB. JURUSAN PPB |
| 5 B.02.1.05 RUANG JURUSAN PLS | 10 B.02.1.14 RUANG JURUSAN KTP | 11 B.02.1.20 TOILET |
| | | 12 B.02.1.21 TOILET |

B.02 ABDULLAH SIGIT B LT. 2

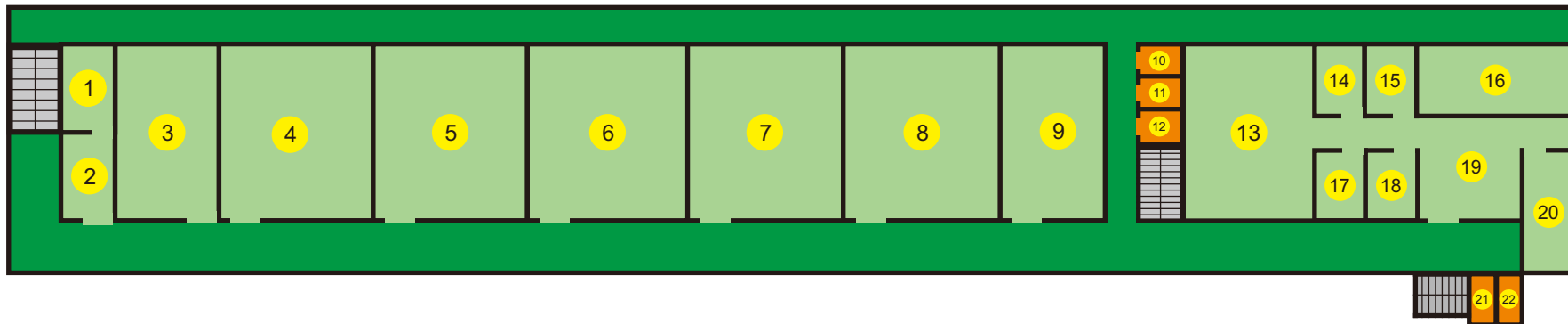

KETERANGAN

- | | | | | |
|-------------------------------|-----------------------------|-------------------------------|----------------------------------|---------------------------|
| 1 B.02.2.01 RUANG KEDAP SUARA | 6 B.02.2.06 RUANG KULIAH 8 | 11 B.02.2.11 TOILET | 16 B.02.2.14 LAB. KOMPUTER TP | 21 B.02.2.21 TOILET PUTRI |
| 2 B.02.2.02 RUANG ARSIP | 7 B.02.2.07 RUANG KULIAH 9 | 12 B.02.2.12 TOILET | 17 B.02.2.17 GUDANG | 22 B.02.2.22 TOILET PUTRA |
| 3 B.02.2.03 RUANG KULIAH 5 | 8 B.02.2.08 RUANG KULIAH 10 | 13 B.02.2.13 LAB. JURUSAN KTP | 18 B.02.2.18 RUANG EDITING | |
| 4 B.02.2.04 RUANG KULIAH 6 | 9 B.02.2.09 RUANG KULIAH 11 | 14 B.02.2.15 RUANG TEKNISI | 19 B.02.2.19 RUANG DISPLAY | |
| 5 B.02.2.05 RUANG KULIAH 7 | 10 B.02.2.10 TOILET | 15 B.02.2.16 RUANG KEPALA LAB | 20 B.02.2.20 LAB. EVALUASI MEDIA | |

B.03 ABDULLAH SIGIT C LT. 1

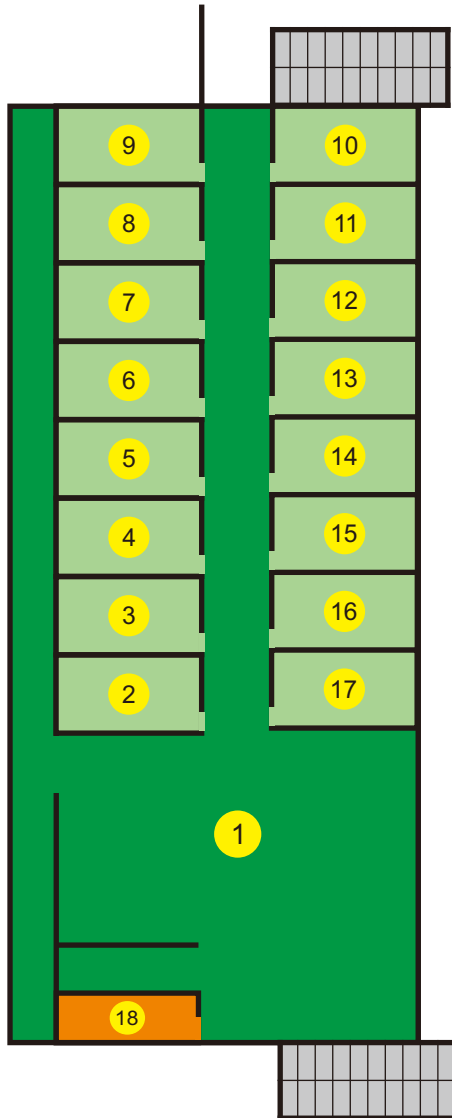

KETERANGAN

- | | |
|------------------------------------|--|
| 1 B.03.01.19 RUANG JURUSAN FSP | 11 B.03.01.10 RUANG DOSEN SENIOR 10 |
| 2 B.03.01.01 RUANG DOSEN SENIOR 1 | 12 B.03.01.11 RUANG DOSEN SENIOR 11 |
| 3 B.03.01.02 RUANG DOSEN SENIOR 2 | 13 B.03.01.12 RUANG DOSEN SENIOR 12 |
| 4 B.03.01.03 RUANG DOSEN SENIOR 3 | 14 B.03.01.13 RUANG DOSEN SENIOR 13 |
| 5 B.03.01.04 RUANG DOSEN SENIOR 4 | 15 B.03.01.14 RUANG DOSEN SENIOR 14 |
| 6 B.03.01.05 RUANG DOSEN SENIOR 5 | 16 B.03.01.15 R. PROF. DR. ROCHMAD WAHAB, M.PD. MA |
| 7 B.03.01.06 RUANG DOSEN SENIOR 6 | 17 B.03.01.16 RUANG DOSEN SENIOR 16 |
| 8 B.03.01.07 RUANG DOSEN SENIOR 7 | 18 B.03.01.17 TOILET |
| 9 B.03.01.08 RUANG DOSEN SENIOR 8 | |
| 10 B.03.01.09 RUANG DOSEN SENIOR 9 | |

B.03 ABDULLAH SIGIT C LT. 1

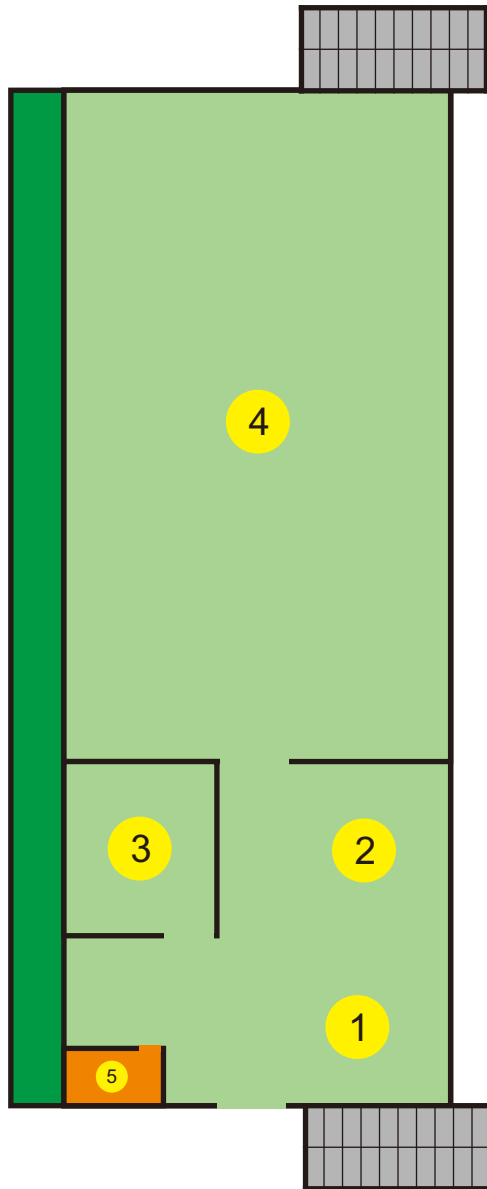

KETERANGAN

- 1 B.03.2.06 RUANG TAMU JURUSAN PSD
- 2 B.03.2.04 RUANG ADMIN JURUSAN PSD
- 3 B.03.2.05 RUANG KETUA JURUSAN PSD
- 4 B.03.2.03 RUANG DOSEN JURUSAN PSD
- 5 B.03.2.01 TOILET JURUSAN PSD

B.04 ABDULLAH SIGIT D LT. 1

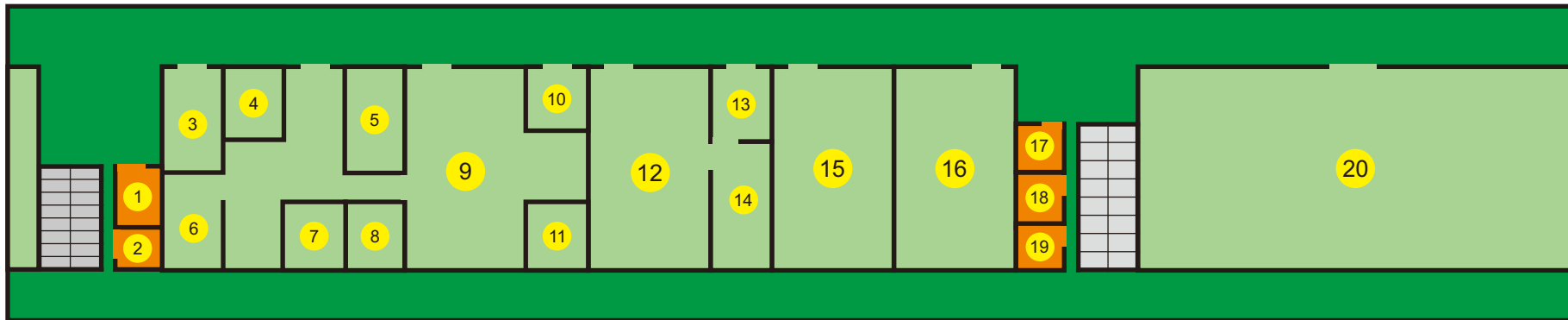

KETERANGAN

- | | | | |
|-------------------------------------|--|---------------------------------|---------------------------------|
| 1 B.04.01.11 TOILET PUTRA | 6 B.04.01.09 GUDANG | 11 B.04.01.15 RUANG TAMU | 16 B.04.01.05 RUANG UJIAN TESIS |
| 2 B.04.01.12 TOILET PUTRI | 7 B.04.01.18 R. ASSESMENT & INTERVENAL | 12 B.04.01.06 LAB. JURUSAN FSP | 17 B.04.01.04 TOILET |
| 3 B.04.01.08 R. PRAKTIK FISIOTERAPI | 8 B.04.01.17 R. LATIHAN BERBICARA | 13 B.04.01.14 RUANG TAMU | 18 B.04.01.03 TOILET |
| 4 B.04.01.20 R. AUDIO METER | 9 B.04.01.07 LAB. JURUSAN PLB | 14 B.04.01.13 R. KEPALA LAB FSP | 19 B.04.01.02 TOILET |
| 5 B.04.01.19 R. LOOPING SISTEM | 10 B.04.01.16 RUANG TEKNISI | 15 B.04.01.10 RUANG UJIAN TESIS | 20 B.04.01.01 RUANG JURUSAN PPB |

B.04 ABDULLAH SIGIT D LT. 2

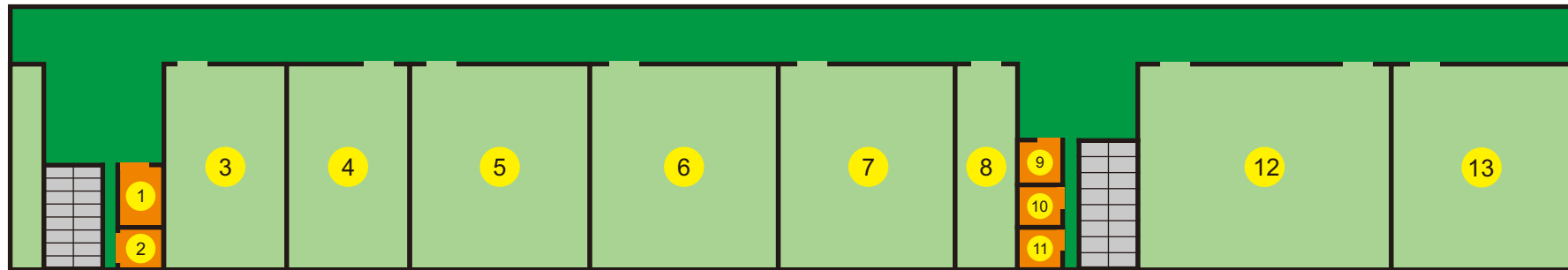

KETERANGAN

- | | |
|------------------------------|--------------------------------|
| 1 B.04.02.11 TOILET PUTRA | 7 B.04.02.04 LAB . KOMPUTER MP |
| 2 B.04.02.10 TOILET PUTRI | 8 B.04.02.03 LAB. MICROLEADING |
| 3 B.04.02.09 RUANG KULIAH 2 | 9 B.04.02.05 TOILET |
| 4 B.04.02.08 RUANG KULIAH 16 | 10 B.04.02.12 TOILET |
| 5 B.04.02.07 RUANG KULIAH 15 | 11 B.04.02.13 TOILET |
| 6 B.04.02.06 RUANG KULIAH 14 | 12 B.04.02.02 RUANG SIDANG 1 |
| | 13 B.04.02.01 RUANG KULIAH 13 |

B.05 GUDANG LANTAI 1 DAN 2

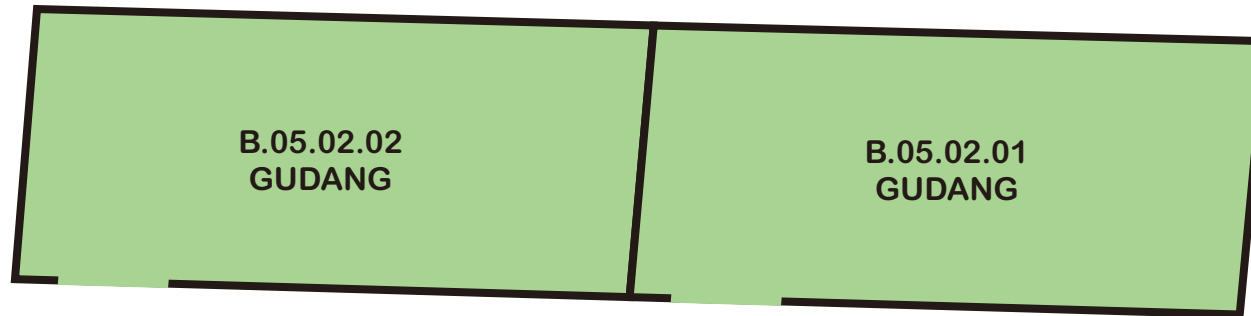

GUDANG LANTAI 2

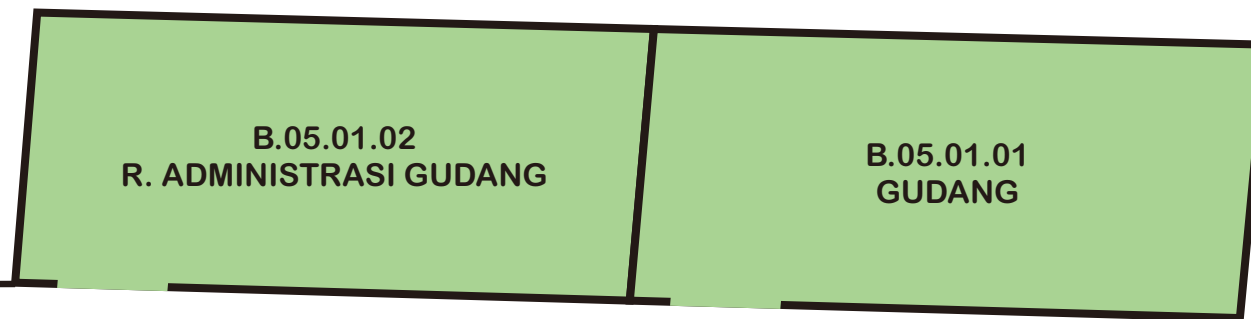

GUDANG LANTAI 1

B.06 GEDUNG ORMAWA LANTAI 1

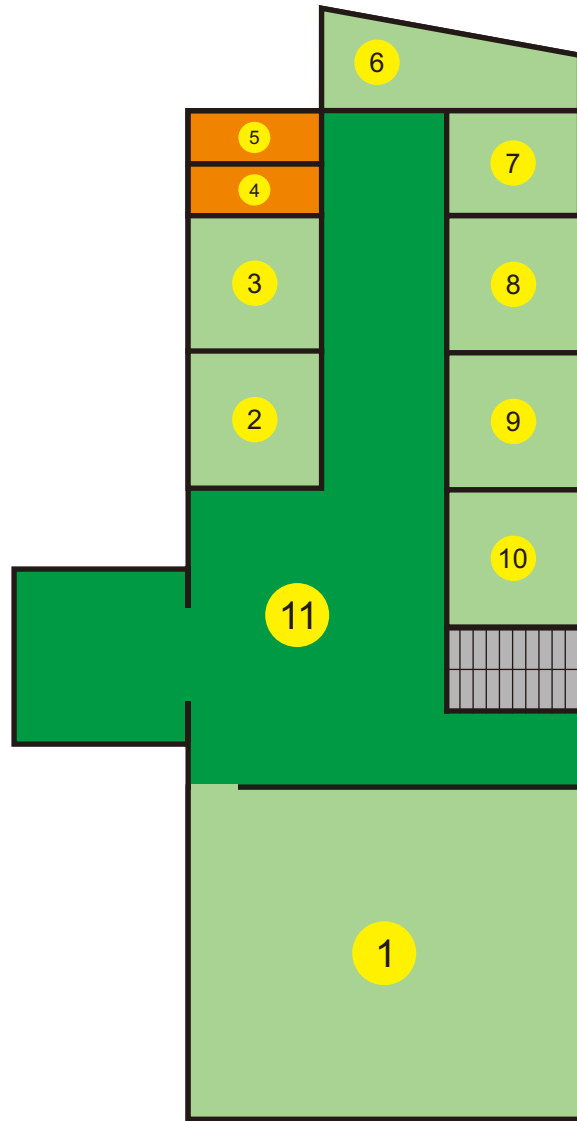

KETERANGAN

- | | | | |
|---|--------------------------------|----|---------------------------|
| 1 | B.06.01.10 RUANG SIDANG ORMAWA | 6 | B.06.01.01 MUSHOLA |
| 2 | B.06.01.05 HIMA PGSD | 7 | B.06.01.07 HIMA PLB |
| 3 | B.06.01.04 UKMF CAMP | 8 | B.06.01.11 UKMF KMIP |
| 4 | B.06.01.03 TOILET PUTRI | 9 | B.06.01.08 UKMF REALITY |
| 5 | B.06.01.02 TOILET PUTRA | 10 | B.06.01.09 HIMA PSIKOLOGI |
| | | 11 | B.06.01.06 LOBI/SELASAR |

B.06 GEDUNG ORMAWA LANTAI 2

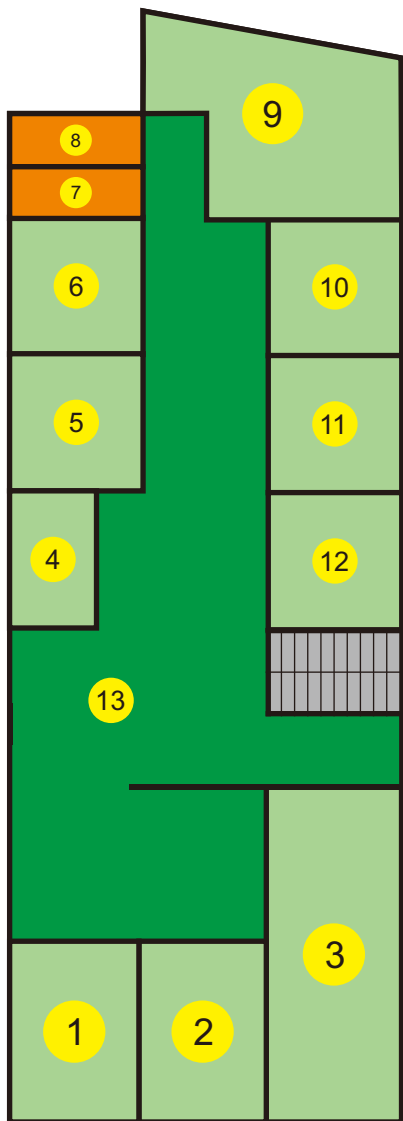

KETERANGAN

- | | |
|---------------------------|-------------------------------|
| 1 B.06.02.00 BEM FIP | 8 B.06.02.02 TOILET PUTRA |
| 2 B.06.02.00 DPM FIP | 9 B.06.02.03 STUDIO UKMF CAMP |
| 3 B.06.02.10 GUDANG | 10 B.06.02.07 HIMA PLS |
| 4 B.06.02.06 HIMA PAUD | 11 B.06.02.08 HIMA AP |
| 5 B.06.02.05 HIMA PPB | 12 B.06.02.09 HIMA KTP |
| 6 B.06.02.04 HIMA KP | 13 B.06.02.06 SELASAR |
| 7 B.06.02.03 TOILET PUTRI | |

B.05 NOENG MUHAJIR LANTAI 1

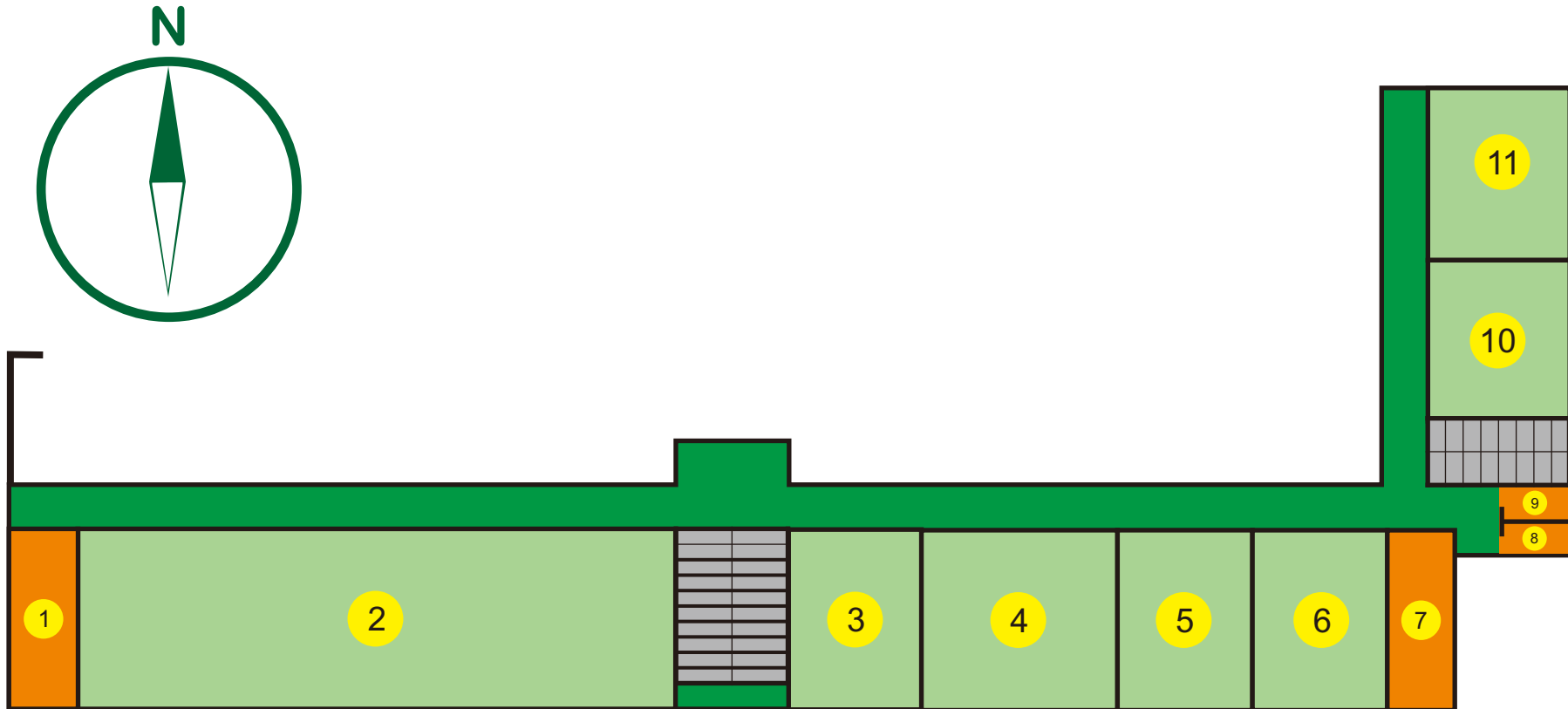

KETERANGAN

- | | |
|--------------------------------|-------------------------------|
| 1 B.05.01.09 TOILET PUTRI | 7 B.05.01.08 TOILET PUTRA |
| 2 B.05.01.11 RUANG JURUSAN PLB | 8 B.05.01.06 TOILET PUTRA |
| 3 B.05.01.03 UPT-LBK | 9 B.05.01.07 TOILET PUTRI |
| 4 B.05.01.04 UPT-LBK | 10 B.05.01.02 RUANG KULIAH 18 |
| 5 B.05.01.05 UPT-LBK | 11 B.05.01.01 RUANG KULIAH 17 |
| 6 B.05.01.10 UPT-LBK | |

B.05 NOENG MUHAJIR LANTAI 2

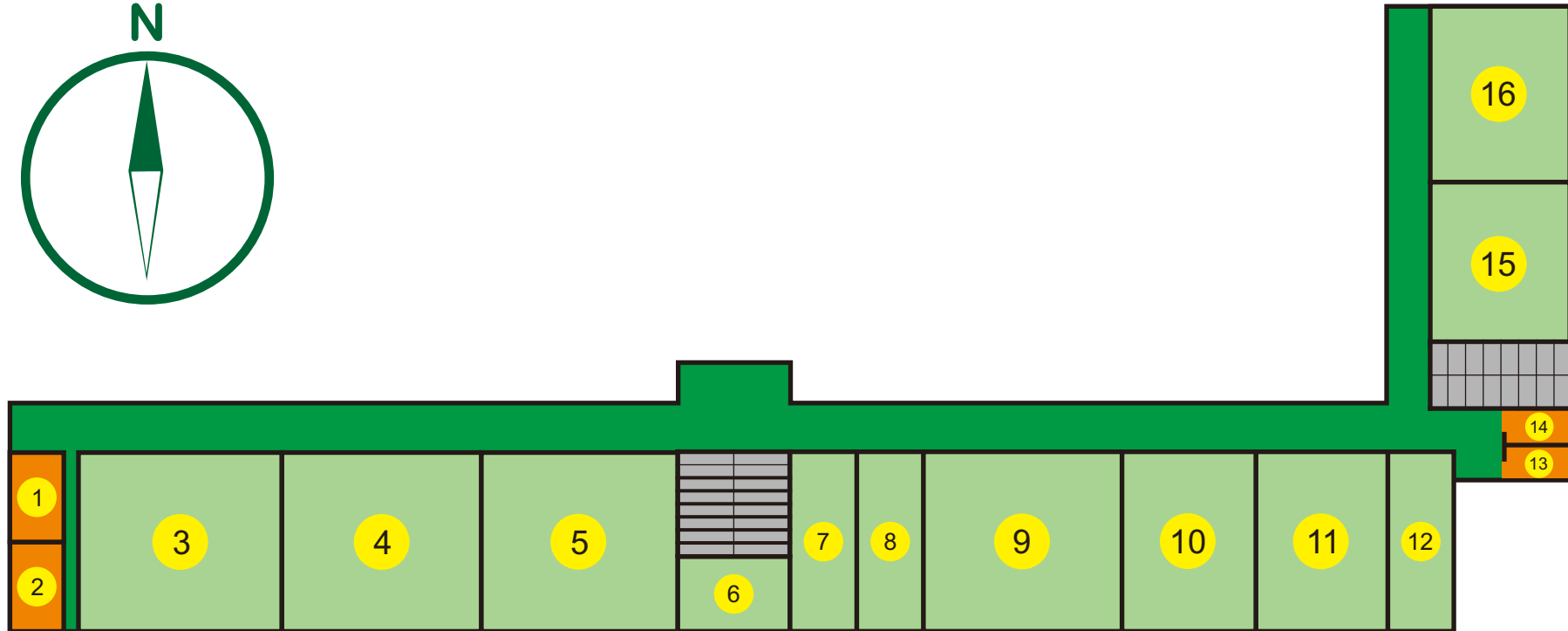

KETERANGAN

- | | | |
|------------------------------|-------------------------------|-------------------------------|
| 1 B.05.02.14 TOILET PUTRA | 6 B.05.02.16 RUANG KMMD | 11 B.05.02.04 RUANG KULIAH 22 |
| 2 B.05.02.15 TOILET PUTRI | 7 B.05.02.08 RUANG UJIAN E | 12 B.05.02.03 RUANG UJIAN G |
| 3 B.05.02.11 RUANG KULIAH 27 | 8 B.05.02.07 RUANG UJIAN F | 13 B.05.02.12 TOILET PUTRA |
| 4 B.05.02.10 RUANG KULIAH 26 | 9 B.05.02.06 RUANG KULIAH 24 | 14 B.05.02.13 TOILET PUTRI |
| 5 B.05.02.09 RUANG KULIAH 25 | 10 B.05.02.05 RUANG KULIAH 23 | 15 B.05.02.02 RUANG KULIAH 21 |
| | | 16 B.05.02.01 RUANG KULIAH 20 |

B.05 NOENG MUHAJIR LANTAI 3

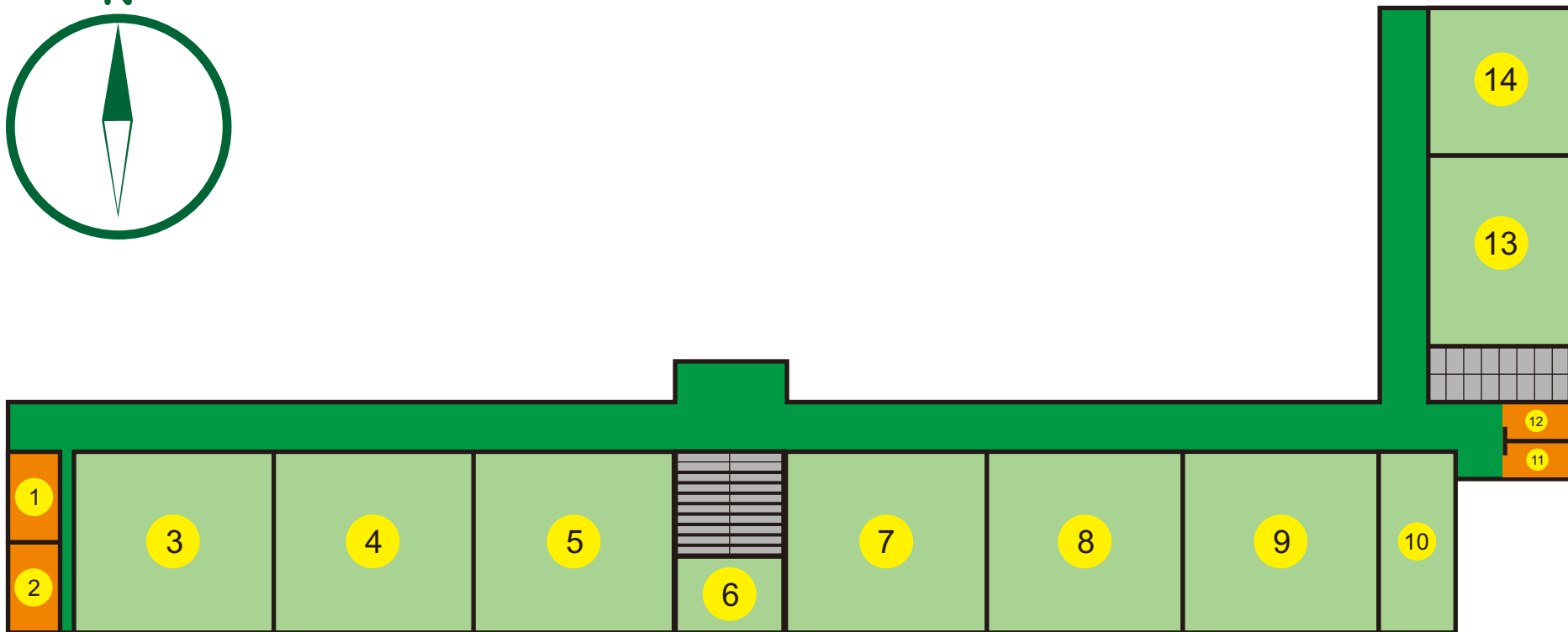

KETERANGAN

- | | | |
|------------------------------|------------------------------|-------------------------------|
| 1 B.05.03.12 TOILET PUTRA | 6 B.05.03.14 UNIT PENELITIAN | 11 B.05.03.10 TOILET PUTRA |
| 2 B.05.03.13 TOILET PUTRA | 7 B.05.03.06 RUANG KULIAH 32 | 12 B.05.03.11 TOILET PUTRI |
| 3 B.05.03.09 RUANG KULIAH 35 | 8 B.05.03.05 RUANG KULIAH 31 | 13 B.05.03.02 RUANG KULIAH 29 |
| 4 B.05.03.08 RUANG KULIAH 34 | 9 B.05.03.04 RUANG KULIAH 30 | 14 B.05.03.01 RUANG KULIAH 28 |
| 5 B.05.03.07 RUANG KULIAH 33 | 10 B.05.03.03 RUANG STAFF | |

B.28 GEDUNG DAKIR BASEMENT

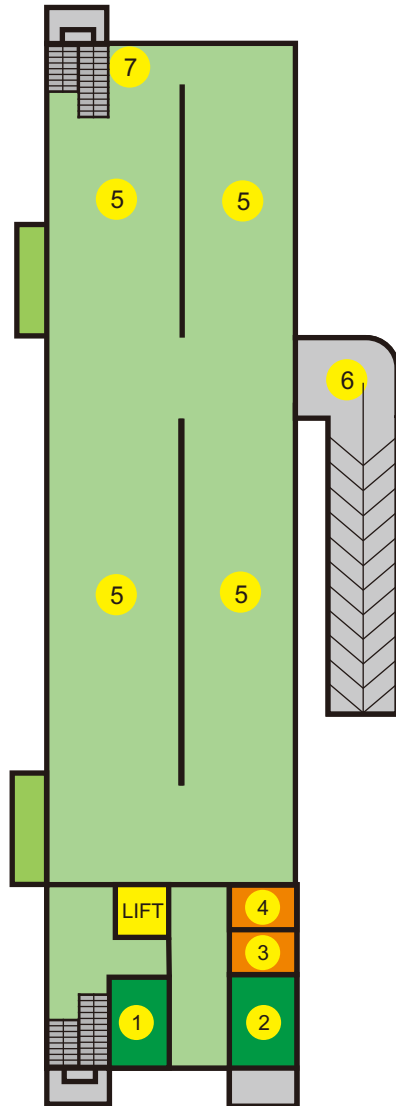

KETERANGAN

- | | |
|----------------------------------|---------------------------|
| 1 B.28.0.01 RUANG PETUGAS GEDUNG | 5 B.28.0.05 TEMPAT PARKIR |
| 2 B.28.0.02 GEDUNG | 6 B.28.0.06 JALAN MASUK |
| 3 B.28.0.03 TOILET PUTRA | 7 B.28.0.07 PANEL |
| 4 B.28.0.04 TOILET PUTRI | |

B.28 GEDUNG DAKIR LANTAI 1

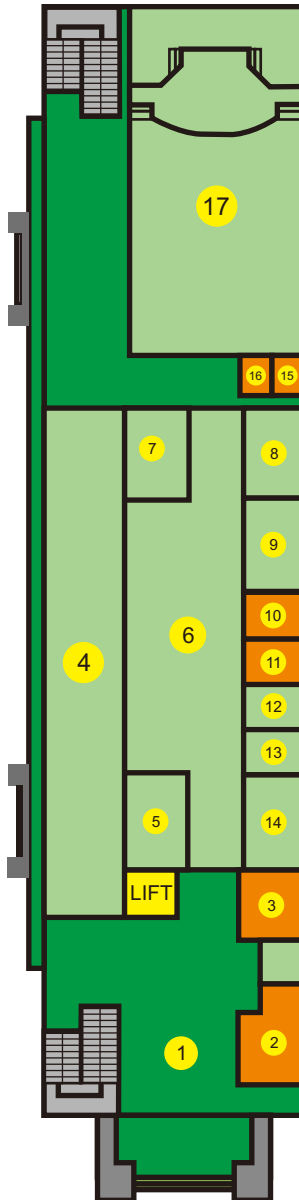

KETERANGAN

- | | | | |
|---|-------------------------------|----|----------------------------------|
| 1 | B.28.01.01 LOBI | 9 | B.28.01.05 RUANG TIDUR |
| 2 | B.28.01.18 TOILET PUTRA | 10 | B.28.01.16 TOILET ANAK PUTRI |
| 3 | B.28.01.19 TOILET PUTRI | 11 | B.28.01.17 TOILET ANAK PUTRA |
| 4 | B.28.01.00 RUANG JURUSAN PAUD | 12 | B.28.01.06 RUANG CCTV |
| 5 | B.28.01.09 RUANG TAMU | 13 | B.28.01.07 RUANG PANEL |
| 6 | B.28.01.03 LAB. JURUSAN PAUD | 14 | B.28.01.08 RUANG KOORDINATOR LAB |
| 7 | B.28.01.10 DAPUR | 15 | B.28.01.14 TOILET PUTRA |
| 8 | B.28.01.04 RUANG MAKAN | 16 | B.28.01.15 TOILET PUTRI |
| | | 17 | B.28.01.02 RUANG THEATER |

B.28 GEDUNG DAKIR LANTAI 2

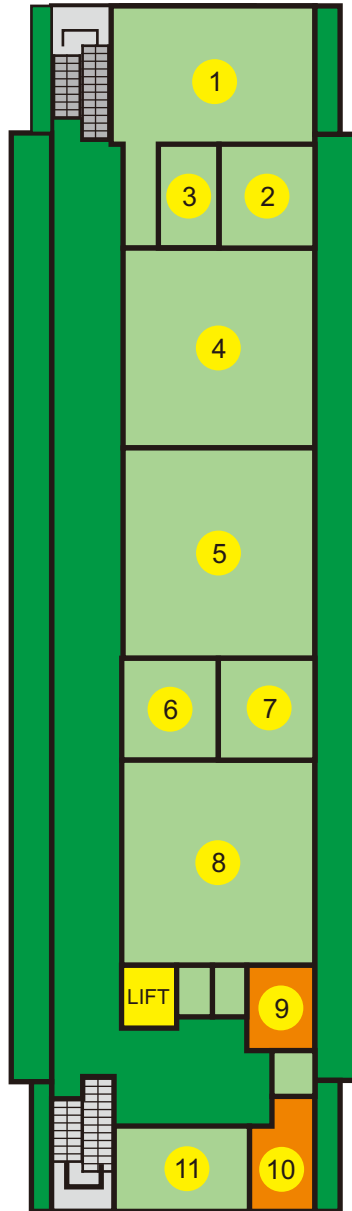

KETERANGAN

- | | |
|-----------------------------------|--------------------------------------|
| 1 B.28.02.01 RUANG VIRTUAL | 6 B.28.02.07 R. KOOR. LAB PENELITIAN |
| 2 B.28.02.02 R. KOOR. LAB TERPADU | 7 B.28.02.10 R. KOOR. LAB DISPLAY |
| 3 B.28.02.17 RUANG KONTROL | 8 B.28.02.13 LAB. DISPLAY |
| 4 B.28.02.05 LAB. TERPADU | 9 B.28.02.14 TOILET PUTRI |
| 5 B.28.02.06 LAB. PENELITIAN | 10 B.28.02.15 TOILET PUTRA |
| | 11 B.28.02.16 RUANG UJIAN |

B.28 GEDUNG DAKIR LANTAI 3

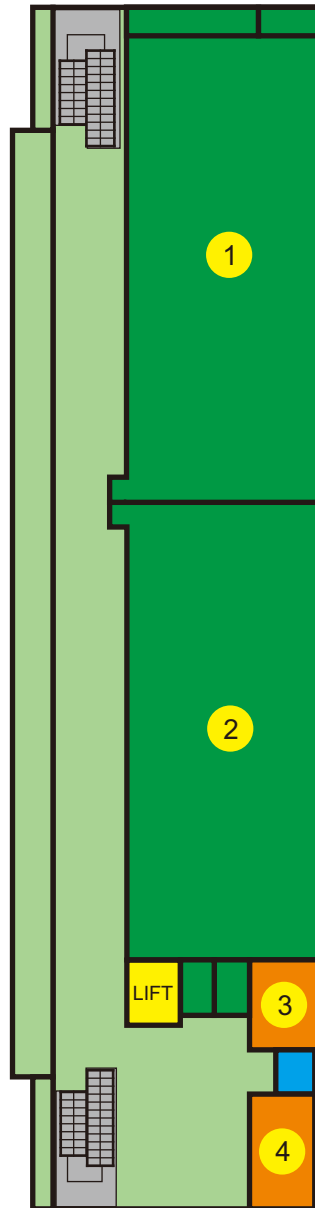

KETERANGAN

- 1 B.28.3.01 RUANG KULIAH 36
- 2 B.28.3.02 RUANG KULIAH 37
- 3 B.28.3.03 TOILET PUTRI
- 4 B.28.3.04 TOILET PUTRA

B.30 GEDUNG MOH AMIN BASEMENT

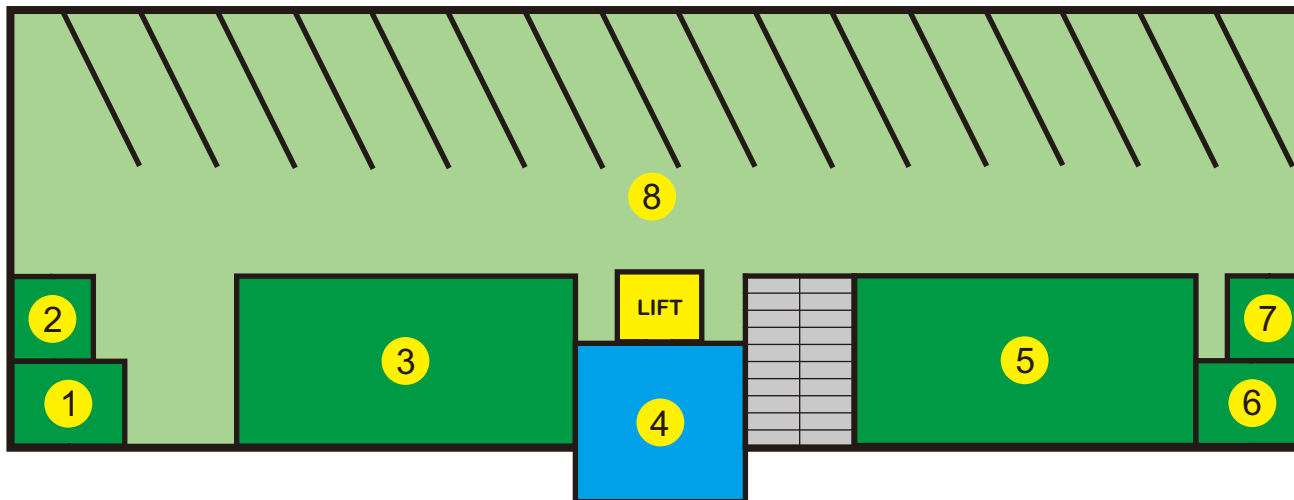

KETERANGAN

- | | |
|-------------------------|-------------------------------|
| 1 B.30.0.01 GUDANG | 5 B.30.0.05 GUDANG PERSEDIaan |
| 2 B.30.0.02 DAPUR | 6 B.30.0.06 GUDANG |
| 3 B.30.0.03 RUANG ARSIP | 7 B.30.0.07 RUANG STAFF |
| 4 B.30.0.04 RUMAH PANEL | 8 B.30.0.08 PARKIR MOBIL |

B.30 GEDUNG MOH AMIN LANTAI 1

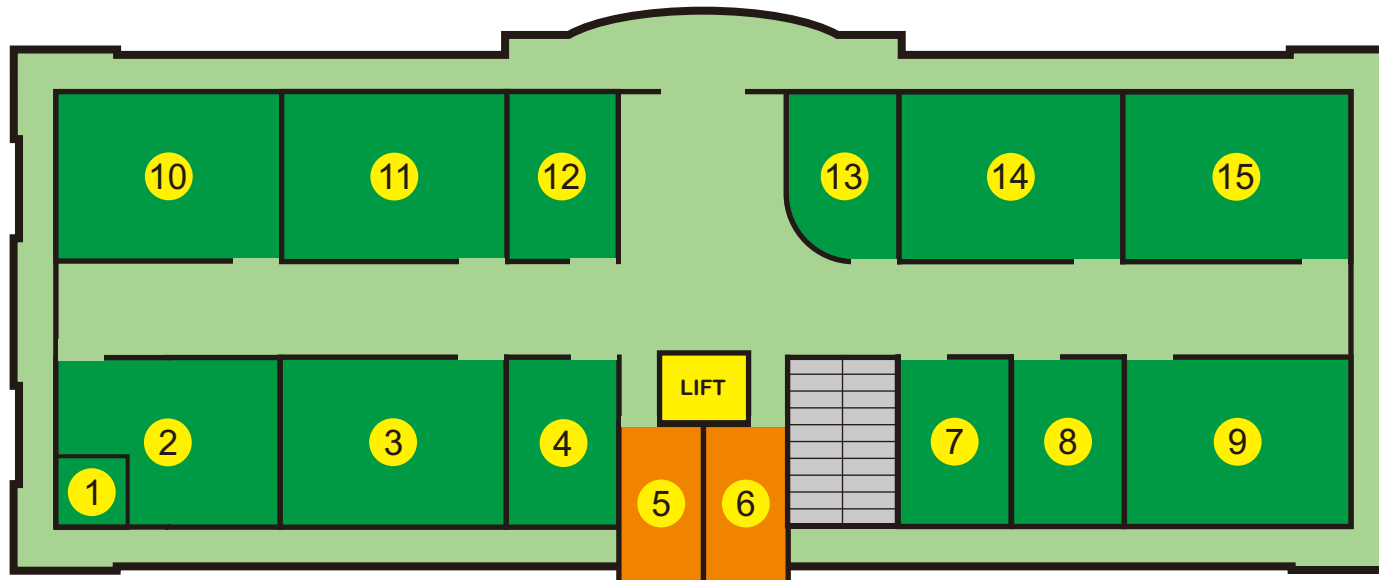

KETERANGAN

- | | | |
|----------------------------------|--------------------------------|---|
| 1 B.30.01.01 RUANG IBADAH | 6 B.30.01.06 TOILET PUTRI | 11 B.30.01.11 RUANG KULIAH 66 |
| 2 B.30.01.02 RUANG TRANSIT DOSEN | 7 B.30.01.07 RUANG UNIT BAHASA | 12 B.30.01.12 R. REVIEWER TESIS & DISERTASI |
| 3 B.30.01.03 RUANG KULIAH 64 | 8 B.30.01.08 RUANG JURNAL | 13 B.30.01.13 FRONT OFFICE |
| 4 B.30.01.04 RUANG ADMIN | 9 B.30.01.09 RUANG KULIAH 69 | 14 B.30.01.14 RUANG KULIAH 67 |
| 5 B.30.01.05 TOILET PUTRA | 10 B.30.01.10 RUANG KULIAH 65 | 15 B.30.01.15 RUANG KULIAH 68 |

B.30 GEDUNG MOH AMIN LANTAI 2

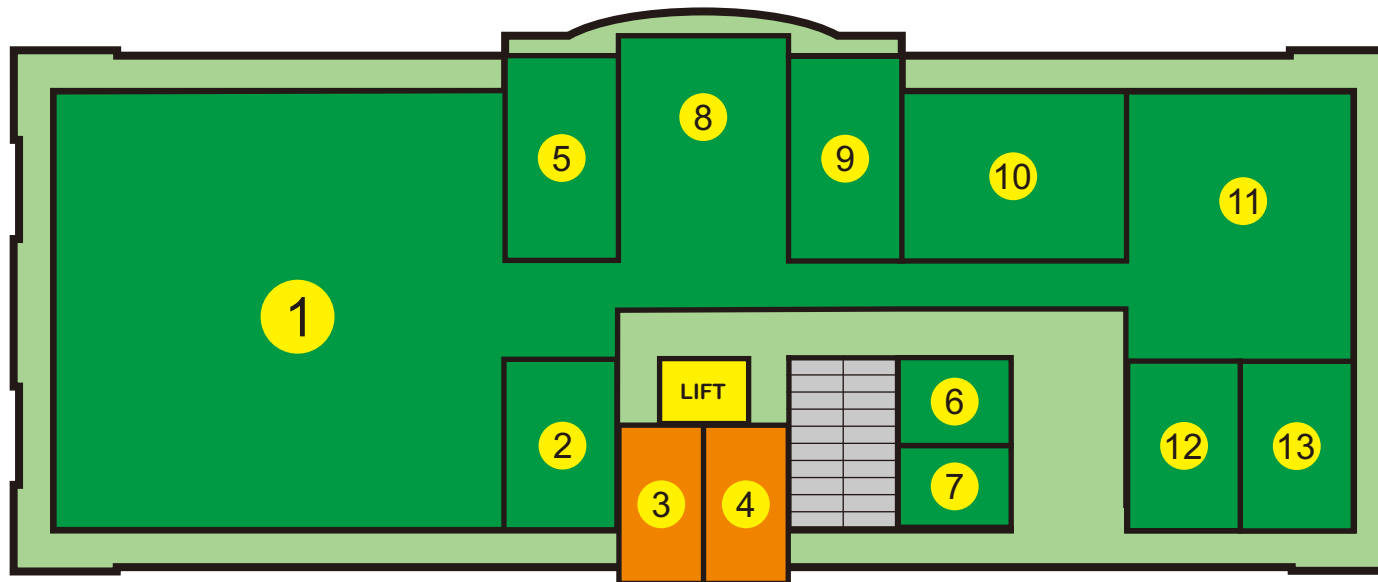

KETERANGAN

- | | | |
|-------------------------------|-------------------------------------|-------------------------------------|
| 1 B.30.02.01 RUANG BUKU | 6 B.30.02.08 MUSHOLA PUTRA | 11 B.30.02.13 RUANG BACA |
| 2 B.30.02.04 RUANG ARSIP | 7 B.30.02.09 MUSHOLA PUTRI | 12 B.30.02.14 RUANG BELAJAR MANDIRI |
| 3 B.30.02.05 RUANG PENGOLAHAN | 8 B.30.02.10 RUANG SIRKULASI | 13 B.30.02.15 RUANG DISKUSI |
| 4 B.30.02.06 TOILET PUTRA | 9 B.30.02.11 LOKER TAS | |
| 5 B.30.02.07 TOILET PUTRI | 10 B.30.02.12 RUANG DIGITAL LIBRARY | |

B.30 GEDUNG MOH AMIN LANTAI 3

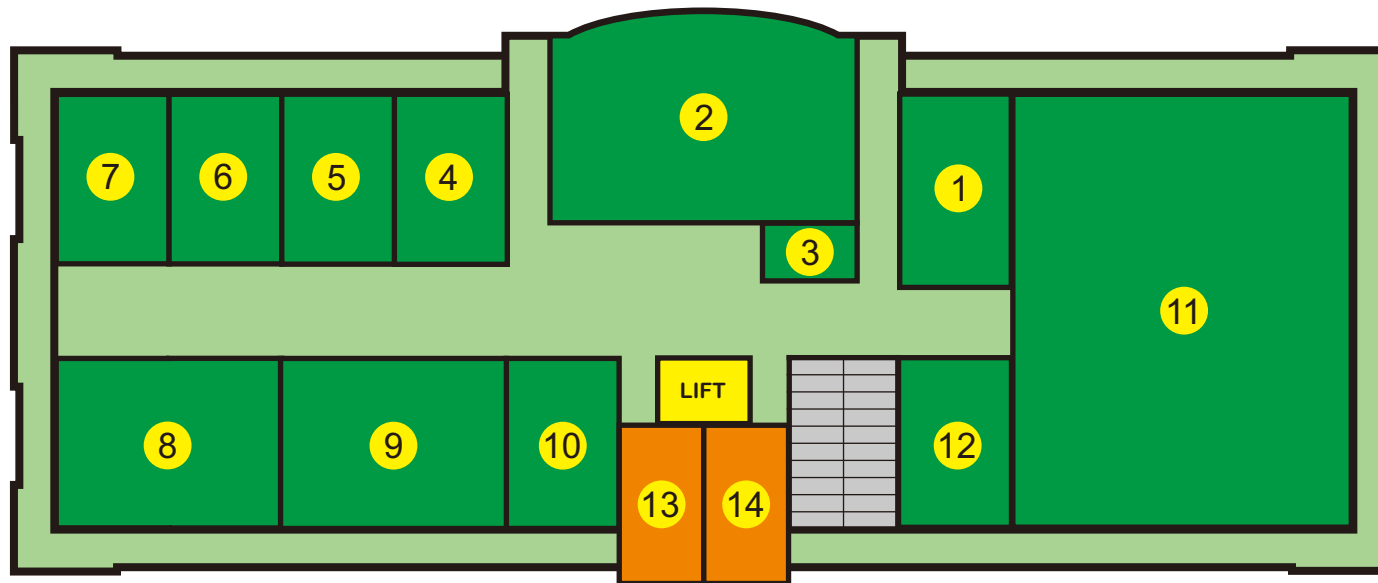

KETERANGAN

- | | | |
|--|--|---------------------------------|
| 1 B.30.3.01 RUANG UJIAN H | 6 B.30.3.06 RUANG KULIAH 70 | 11 B.30.3.04 RUANG SIDANG |
| 2 B.30.3.02 RUANG KOORDINATOR PRODI S2 | 7 B.30.3.06 RUANG KULIAH 71 | 12 B.30.3.04 RUANG TUNGGU DOSEN |
| 3 B.30.3.03 RUANG PERSIAPAN UJIAN | 8 B.30.3.01 RUANG KULIAH INTERNASIONAL A | 13 B.30.3.06 TOILET PUTRI |
| 4 B.30.3.04 RUANG KOORDINATOR PRODI S3 | 9 B.30.3.02 RUANG KULIAH INTERNASIONAL B | 14 B.30.3.06 TOILET PUTRA |
| 5 B.30.3.04 RUANG UJIAN I | 10 B.30.3.03 RUANG DOSEN SENIOR | |

B. 31 GEDUNG PARKIR BASEMENT

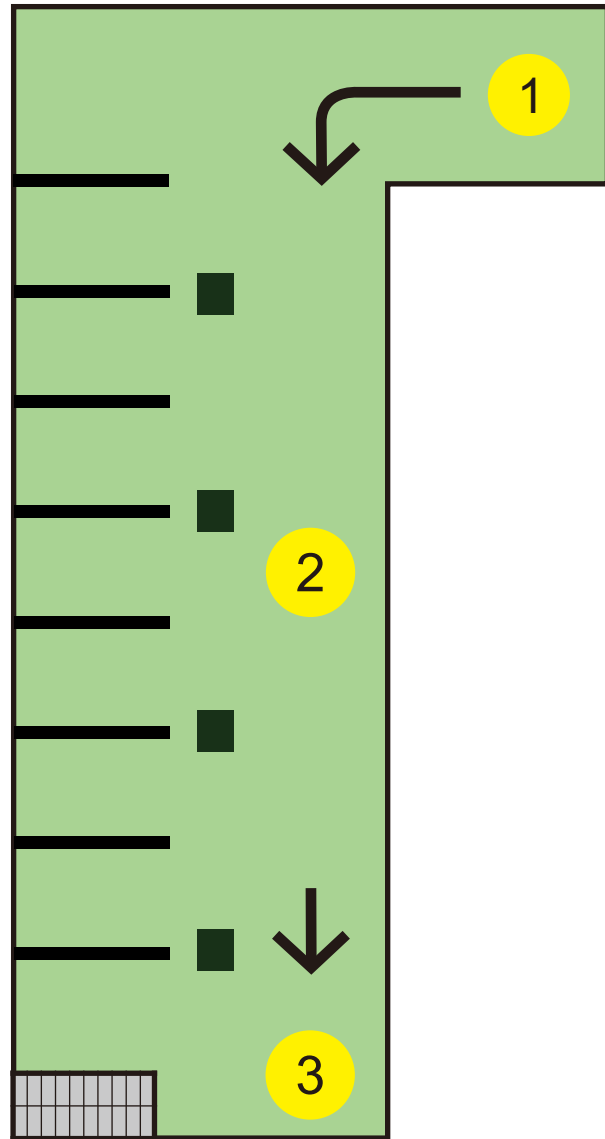

KETERANGAN

- 1 JALAN MASUK
- 2 PARKIR MOBIL
- 3 JALAN KELUAR

B.31 GEDUNG PARKIR LANTAI 1

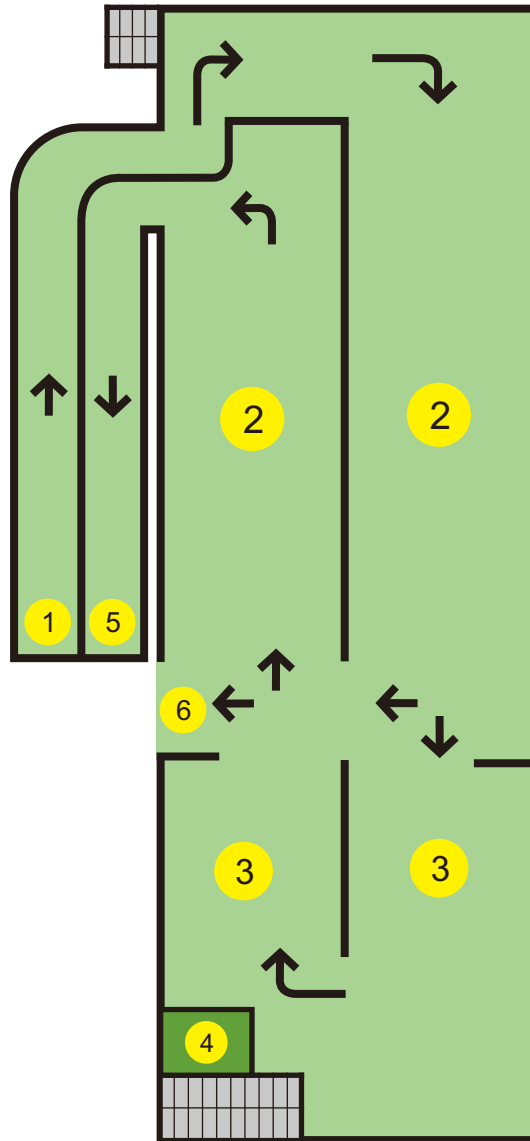

KETERANGAN

- | | |
|-----------------------|---------------------|
| 1 JALAN NAIK | 4 PETUGAS PARKIR |
| 2 PARKIR MAHASISWA | 5 JALAN KELUAR |
| 3 PARKIR DOSEN&TENDIK | 6 JALAN KE LANTAI 2 |

B.31 GEDUNG PARKIR LANTAI 2

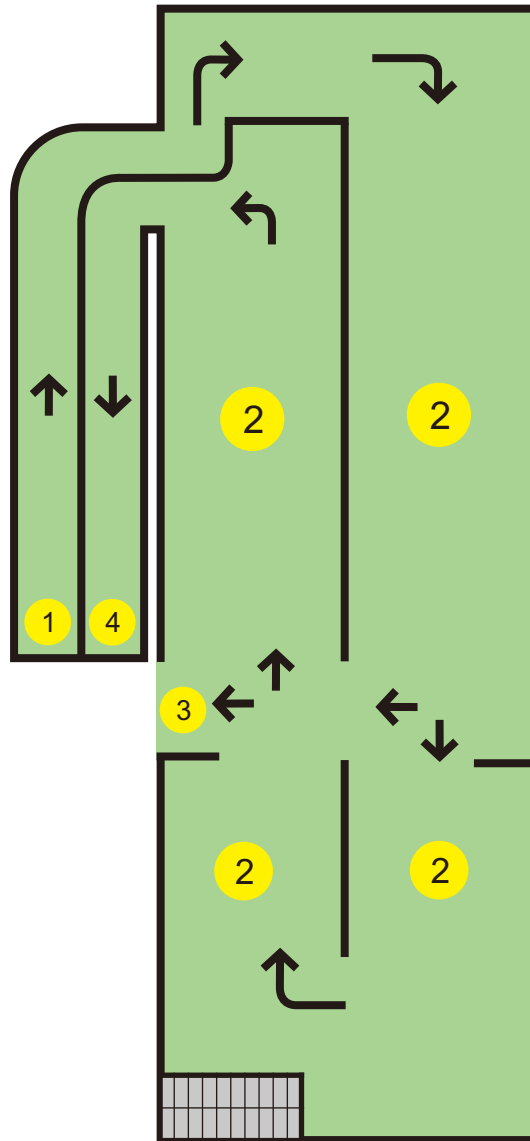

KETERANGAN

- 1 JALAN MASUK
- 2 PARKIR MAHASISWA
- 3 JALAN KE LANTAI 3
- 4 JALAN KELUAR

B.31 GEDUNG PARKIR LANTAI 3

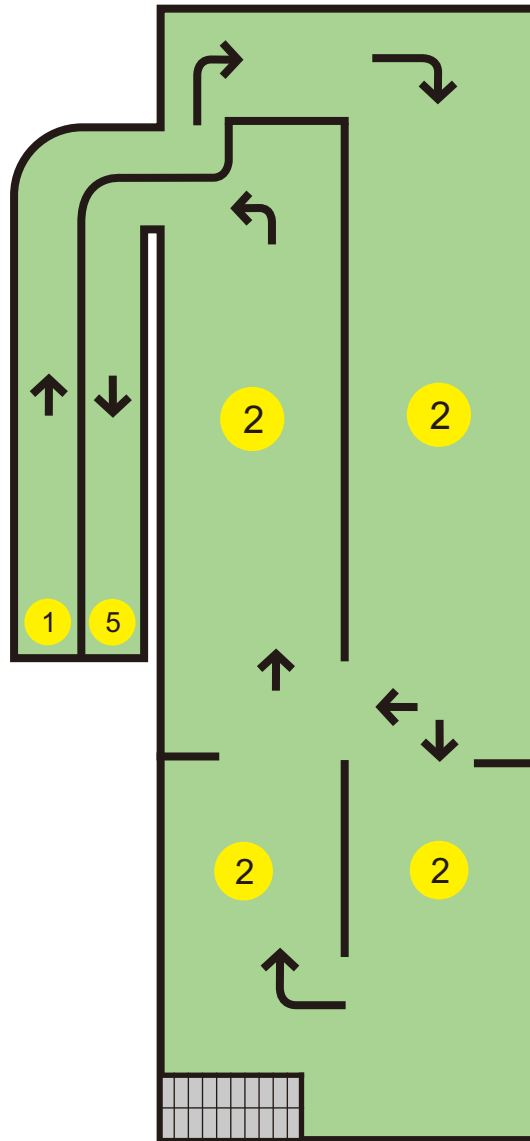







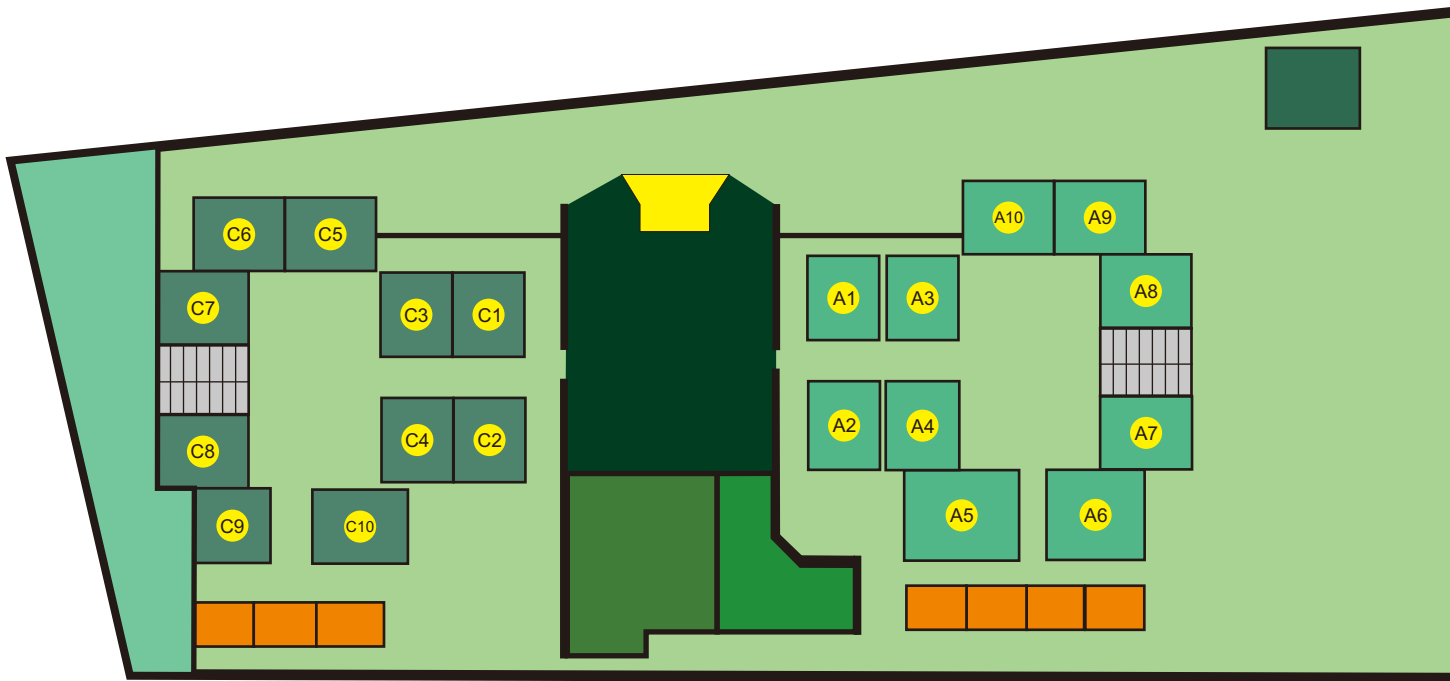



KETERANGAN

- 1 JALAN MASUK
- 2 PARKIR MAHASISWA
- 3 JALAN KELUAR

B.14 ASRAMA KAMPUS II



KETERANGAN

- | | | |
|--|--|---|
|  B.14.1.14 RUANG ADMIN |  B.14.1.00 KAMAR BLOK A |  B.14.1.17 HALAMAN |
|  B.14.1.13 R. KEPALA ASRAMA |  B.14.1.00 KAMAR BLOK C |  B.14.1.18 TOILET |
|  B.14.1.01 AULA ASRAMA |  B.14.1.15 GUDANG | |
|  B.14.1.14 RUANG ADMIN |  B.14.1.16 POS SATPAM | |

B.14 ASRAMA KAMPUS II

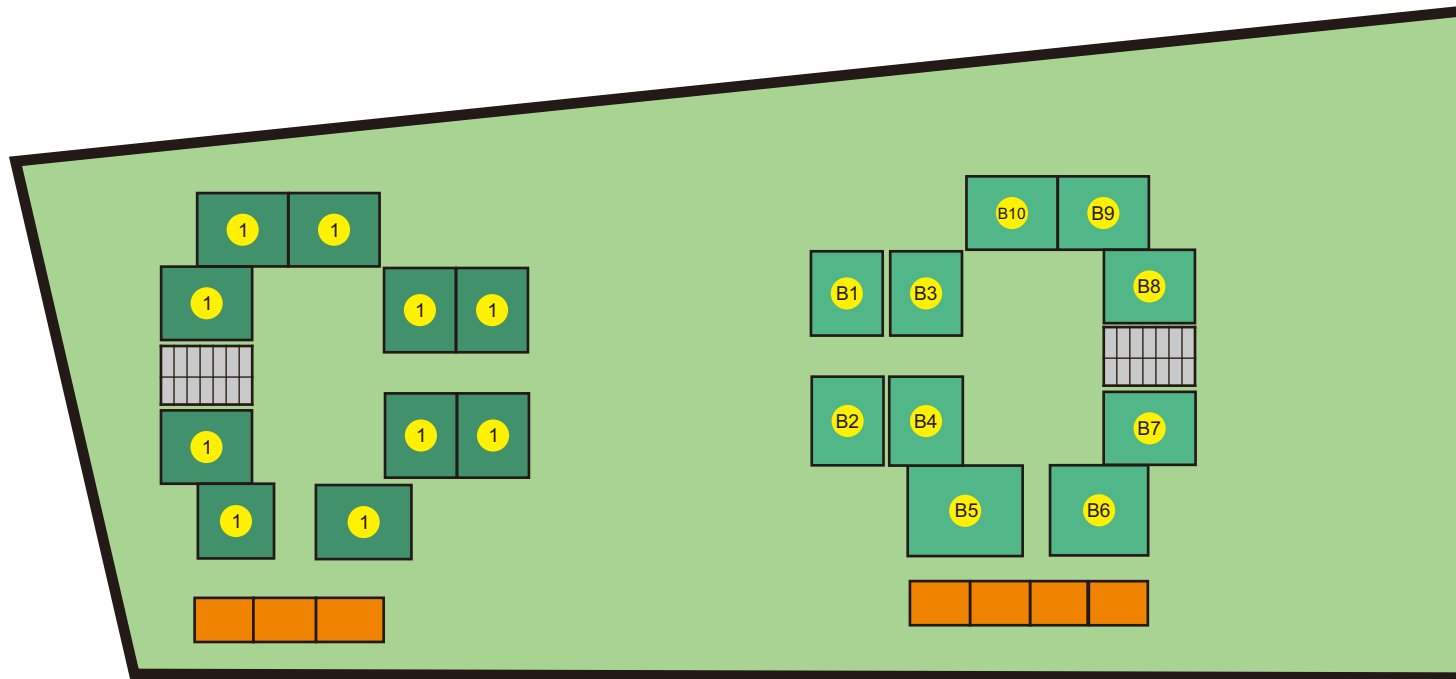

KETERANGAN

 B.14.2.00 KAMAR BLOK B

 B.14.2.11 TOILET

 B.14.2.00 KAMAR BLOK D

 B.14.2.12 HALAMAN

B.20 ASRAMA CONDRONEGARAN

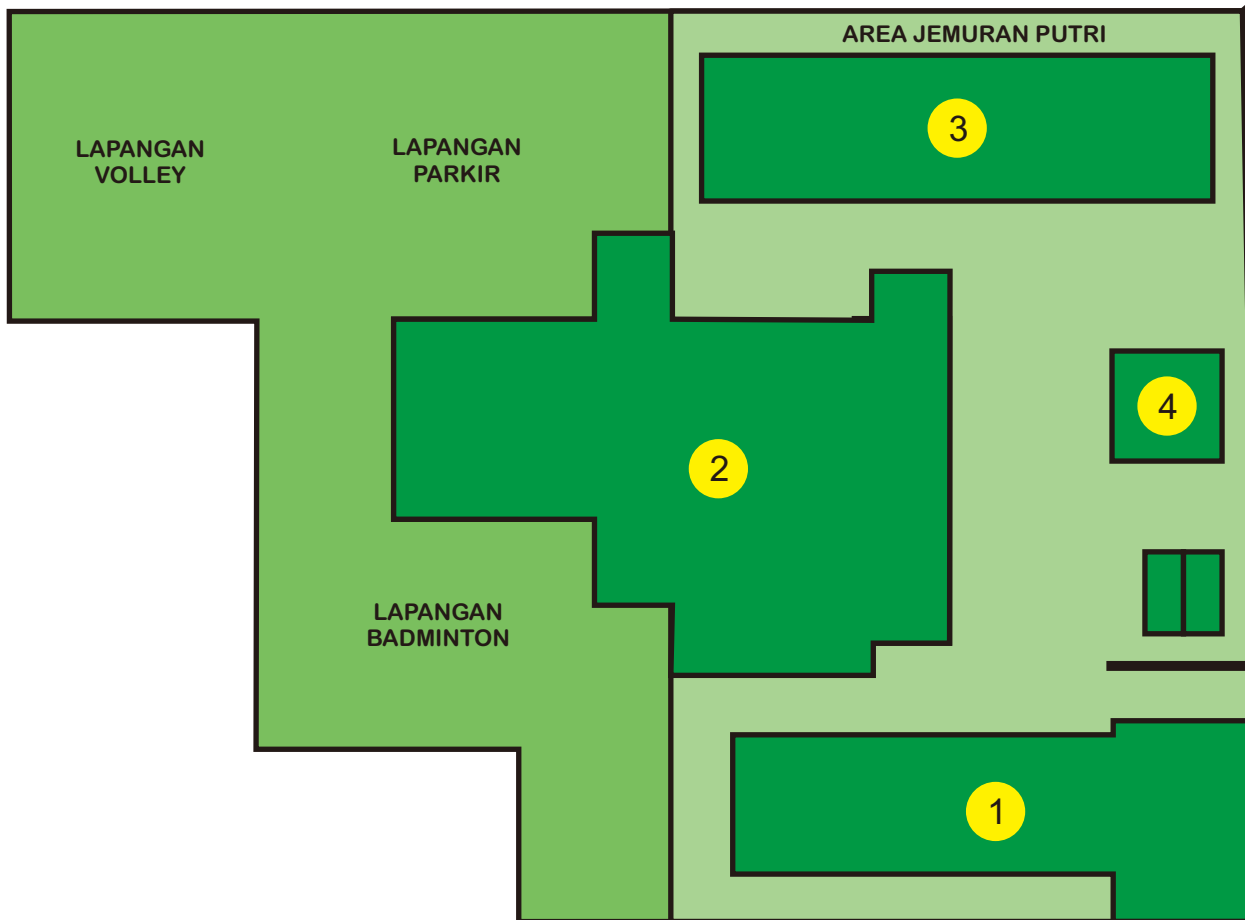

KETERANGAN

- 1 B.23 ASRAMA SAYAP TIMUR
- 2 B.25 ASRAMA TENGAH
- 3 B.22 ASRAMA SAYAP BARAT
- 4 B.20 MUSHOLA ASRAMA

B.20 MUSHOLA CONDRONEGARAN

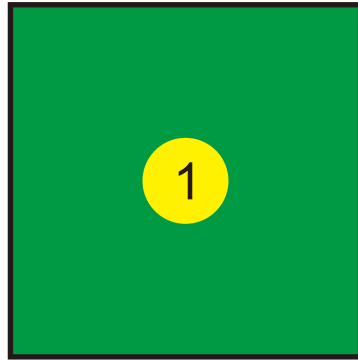

KETERANGAN

- 1 B.20.1.01 MUSHOLA
- 2 B.20.1.02 WUDHU PUTRA
- 3 B.20.1.03 WUDHU PUTRI

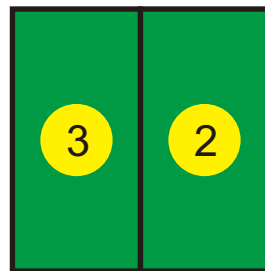

B.23 ASRAMA SAYAP TIMUR

LANTAI 2



LANTAI 1

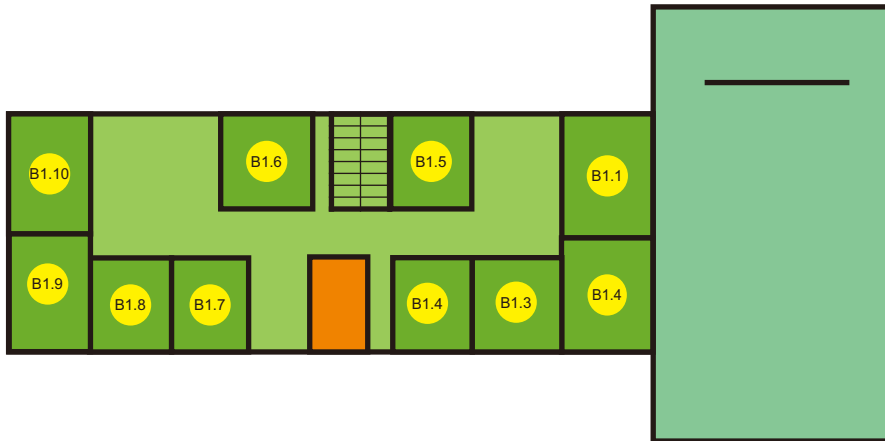

KETERANGAN

-  B.23.1 KAMAR ASRAMA TIMUR BAWAH
-  B.23.2 KAMAR ASRAMA TIMUR ATAS
-  B.23.1 GUDANG
-  B.23.1 TOILET

B.22 ASRAMA SAYAP BARAT

LANTAI 2

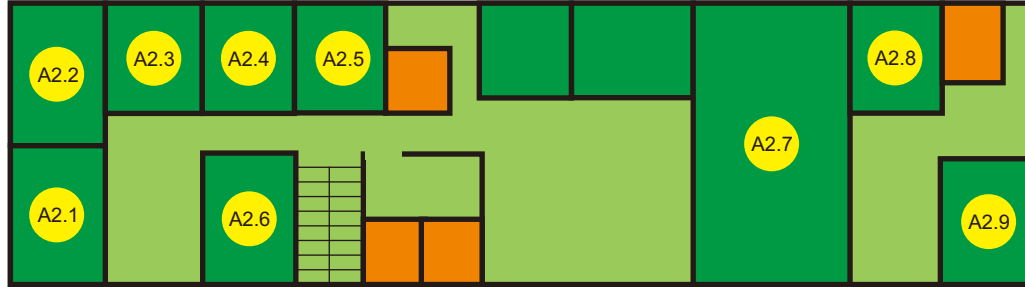

LANTAI 1

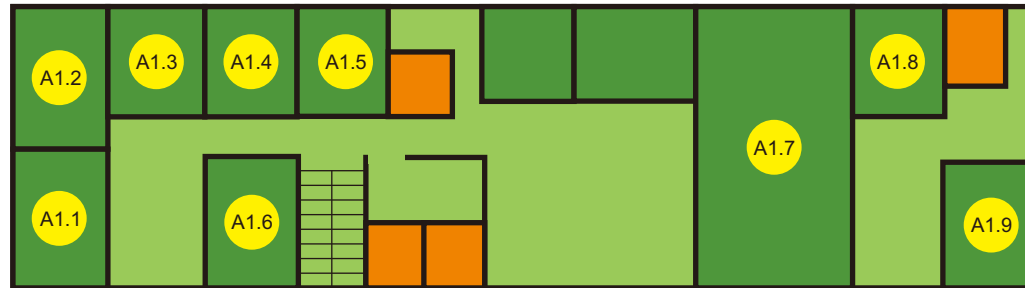

KETERANGAN

-  B.22.1 KAMAR ASRAMA BARAT BAWAH
-  B.22.2 KAMAR ASRAMA BARAT ATAS
-  B.23.1 TOILET

B.25 ASRAMA TENGAH

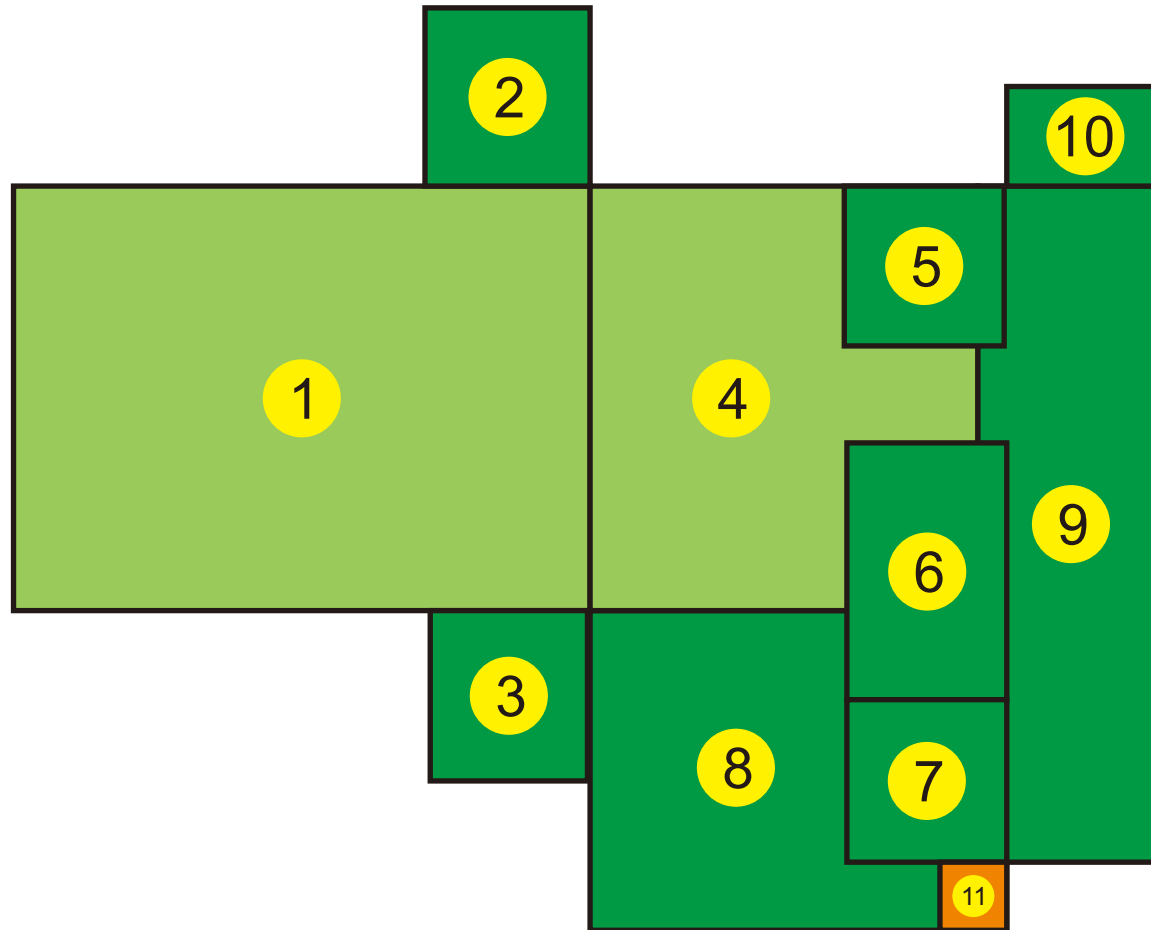

KETERANGAN

- 1 B.25.1.01 PENDOPO LUAR
- 2 B.25.1.02 RUANG PENJAGA
- 3 B.25.1.03 RUANG PENJAGA
- 4 B.25.1.11 RUANG MAKAN
- 5 B.25.1.09 KANTOR KEPALA ASRAMA
- 6 B.25.1.05 R. TAMU KEPALA ASRAMA
- 7 B.25.1.04 R. BELAJAR ASRAMA
- 8 B.25.1.12 DAPUR
- 9 B.25.1.10 KAMAR KEPALA ASRAMA
- 10 B.25.1.06 GUDANG
- 10 B.25.1.13 TOILET

KAMPUS 3 JALAN BANTUL

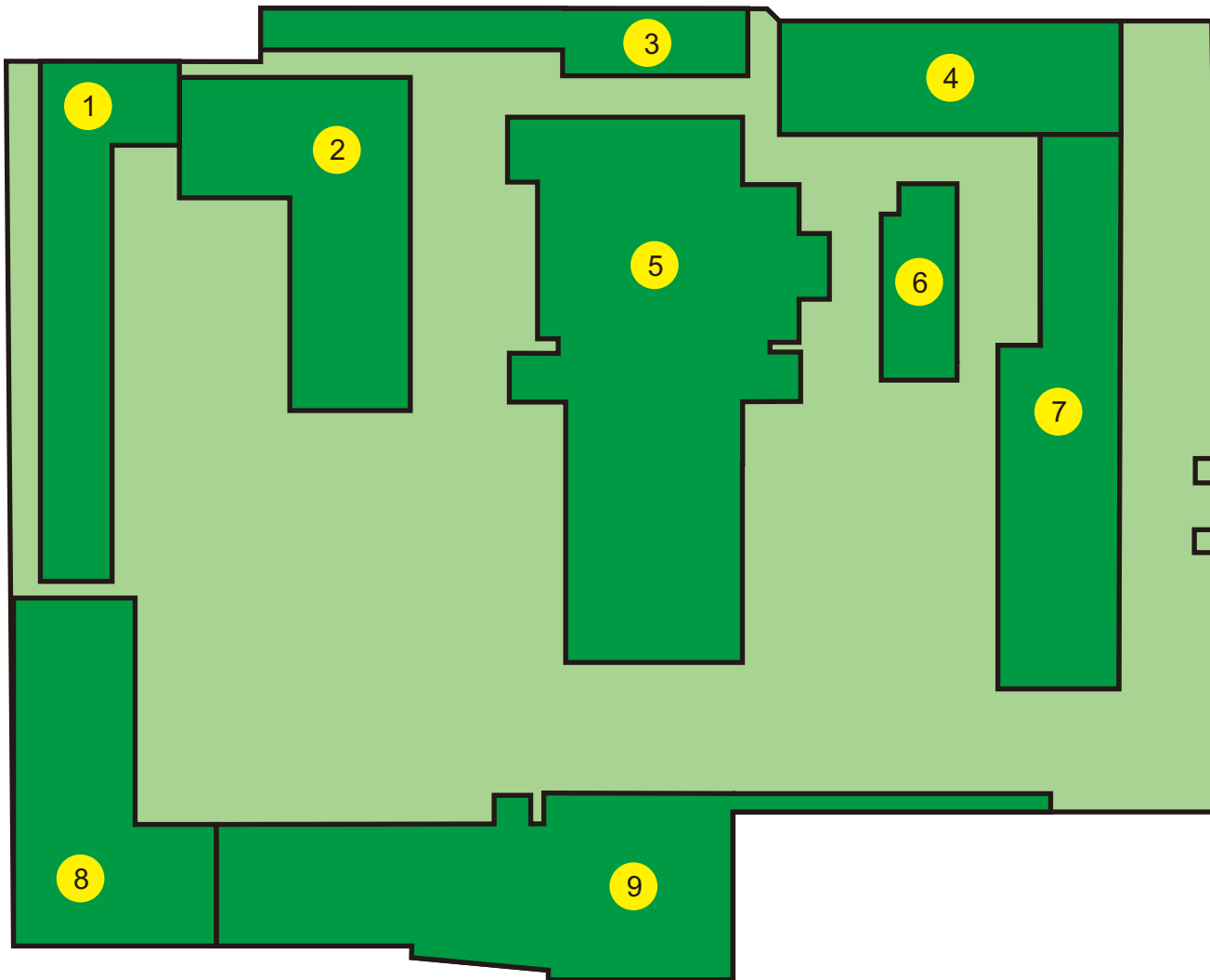

KETERANGAN

- 1 B. 24 GEDUNG KULIAH 36-37
- 2 B. 26 GEDUNG KULIAH 55-59
- 3 B.19 GEDUNG LAB MICRO & UKM
- 4 B.18.1.00 RUANG SIDANG
- 5 B.18 GEDUNG TU & PENDOPO
- 6 B.16 GEDUNG LAB IPA & KOMPUTER
- 7 B.15 GEDUNG KULIAH 51-53
- 8 B. 21 GEDUNG KULIAH 31-35
- 9 B.17 TK PEDAGOGIA

B.15 GEDUNG KULIAH 51-53

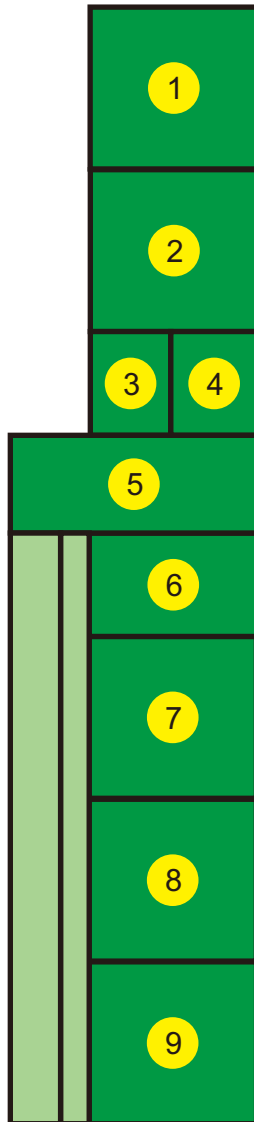

KETERANGAN

- | | |
|---------------------------------|-----------------------------|
| 1 B.15.1.3 RUANG KULIAH 51 | 6 B.15.1.08 RUANG KULIAH 53 |
| 2 B.15.1.7 RUANG KULIAH 52 | 7 B.15.1.4 LAB MUSIK PGPAUD |
| 3 B.15.1.9 RUANG TAMU | 8 B.15.1.2 LAB. PGSD |
| 4 B.15.1.6 RUANG IBADAH | 9 B.15.1.1 LAB. PGPAUD |
| 5 B.15.1.05 RUANG TRANSIT DOSEN | |

B.16 LAB IPA & KOMPUTER

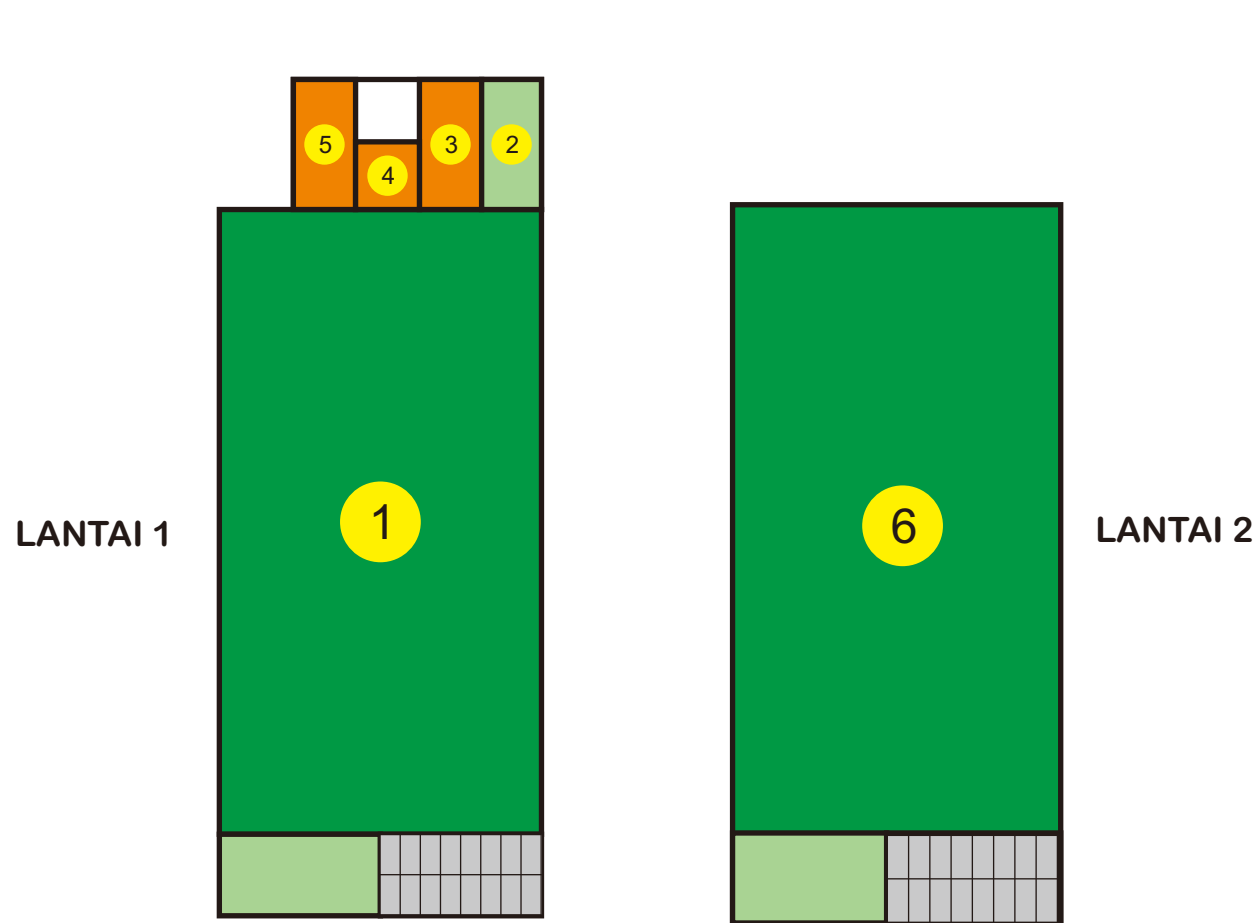

KETERANGAN

- | | |
|-----------------------|--------------------------|
| 1 B.16.1.02 LAB IPA | 4 B.16.1.04 TOILET |
| 2 B.16.1.01 RUANG UKS | 5 B.16.1.05 TOILET |
| 3 B.16.1.03 TOILET | 6 B.16.2.01 LAB KOMPUTER |

B.17 TK PEDAGOGIA

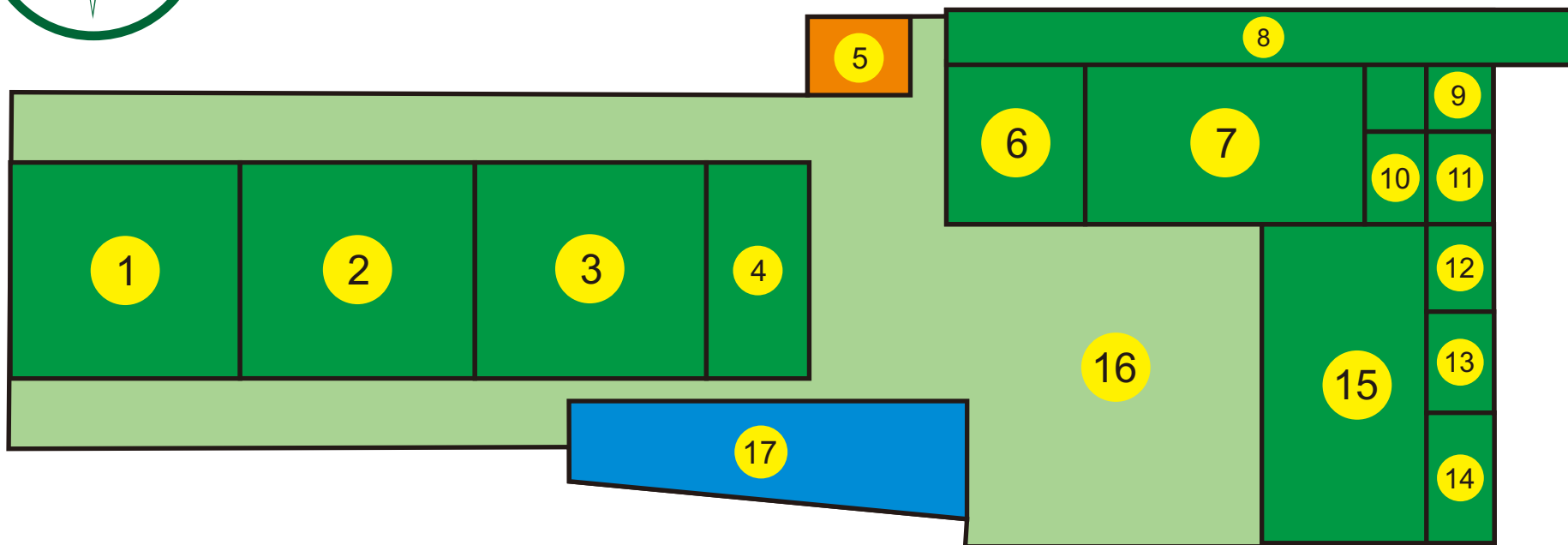

KETERANGAN

- 1 B.17.01.01 RUANG YUDISTIRA
- 2 B.17.01.02 RUANG BIMA
- 3 B.17.01.03 R. NAKULA SADEWA
- 4 B.17.01.04 RUANG IBADAH
- 5 B.17.01.05 TOILET

- 6 B.17.01.06 RUANG ARJUNA
- 7 B.17.01.07 RUANG KRESNA
- 8 B.17.01.08 PARKIR TK PEDAGOGIA
- 9 B.17.01.09 PERPUSTAKAAN
- 10 B.17.01.10 RUANG TU

- 11 B.17.01.11 RUANG KEPALA SEKOLAH
- 12 B.17.01.12 RUANG KONSELING
- 13 B.17.01.13 RUANG UKS
- 14 B.17.01.14 DAPUR
- 15 B.17.01.15 SERAMBI

- 16 B.17.01.16 PLAYGROUND
- 17 B.17.01.17 KOLAM RENANG

B.18 TU & PENDOPO

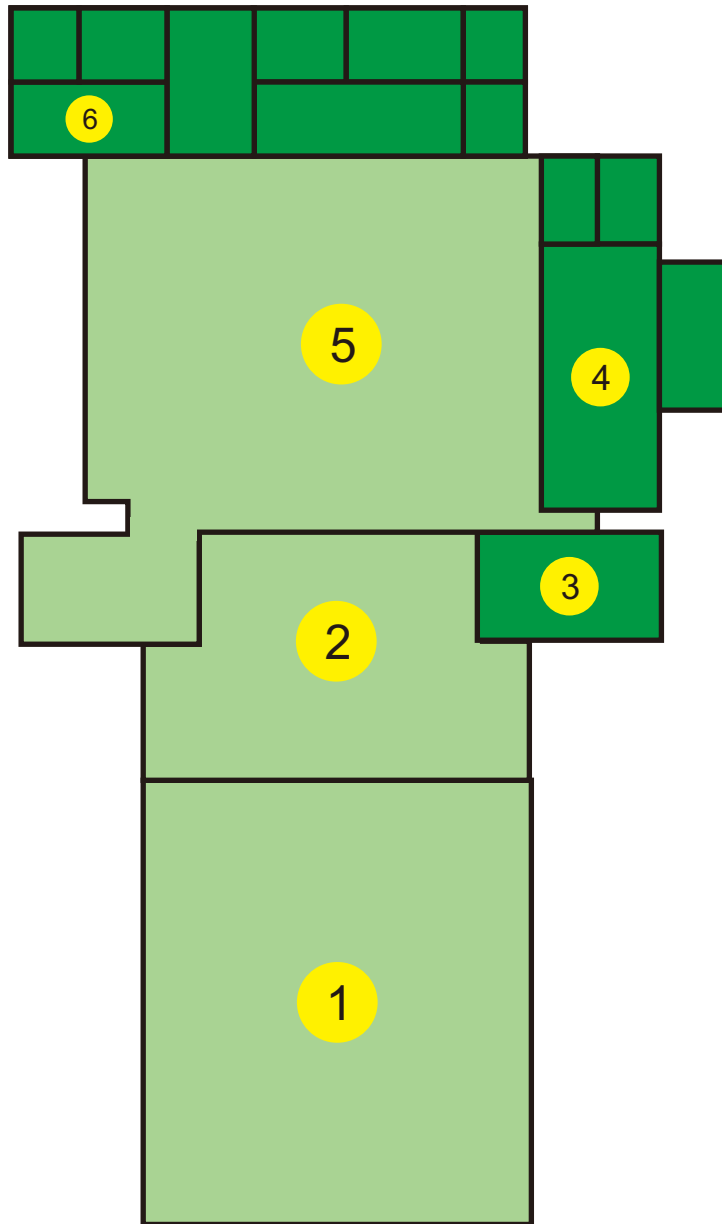

KETERANGAN

- 1 B.18.1.00 PENDOPO LUAR
- 2 B.18.1.00 SERAMBI
- 3 B.18.1.00 RUANG TATA USAHA
- 4 B.18.1.00 RUANG SIDANG
- 5 B.18.1.00 RUANG KULIAH 54
- 6 B.18.1.00 MUSHOLA

B.19 LAB MICRO DAN UKM

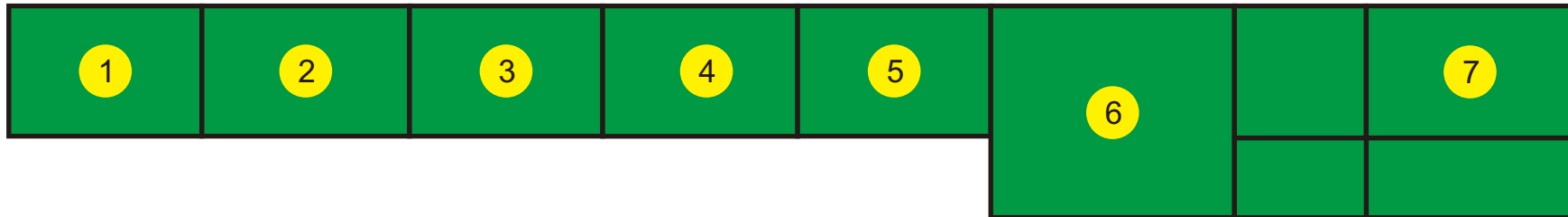

KETERANGAN

- | | |
|-------------------------------|-------------------------------|
| 1 B.19.01.01 R. MICROTEACHING | 5 B.19.01.05 R. MICROTEACHING |
| 2 B.19.01.02 R. MICROTEACHING | 6 B.19.01.06 HIMA PGSD |
| 3 B.19.01.03 R. MICROTEACHING | 7 B.31.01.07 KANTIN |
| 4 B.19.01.04 R. MICROTEACHING | |

B.21 GEDUNG KULIAH 31 - 35

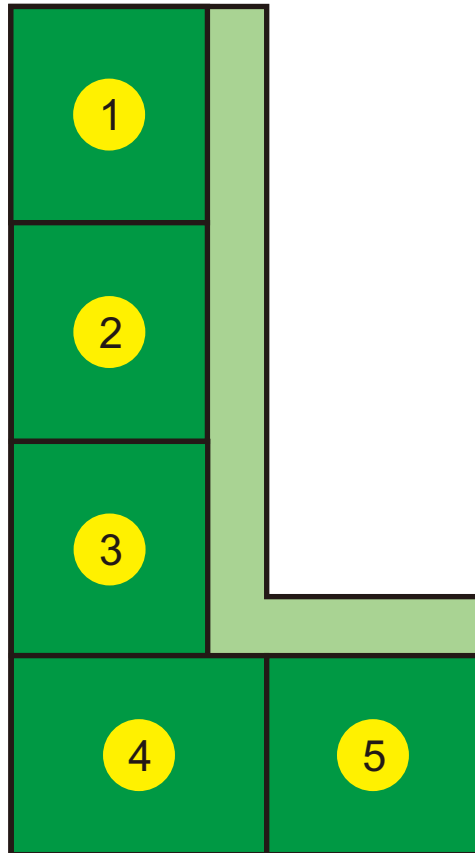

KETERANGAN

- 1 B.21.1.01 RUANG GURU B
- 2 B.21.1.02 RUANG GURU A
- 3 B.21.1.03 RUANG KELAS 1B
- 4 B.21.1.04 RUANG KELAS 1A
- 5 B.21.1.05 RUANG TU

B.24 KAMPUS 3 JALAN BANTUL

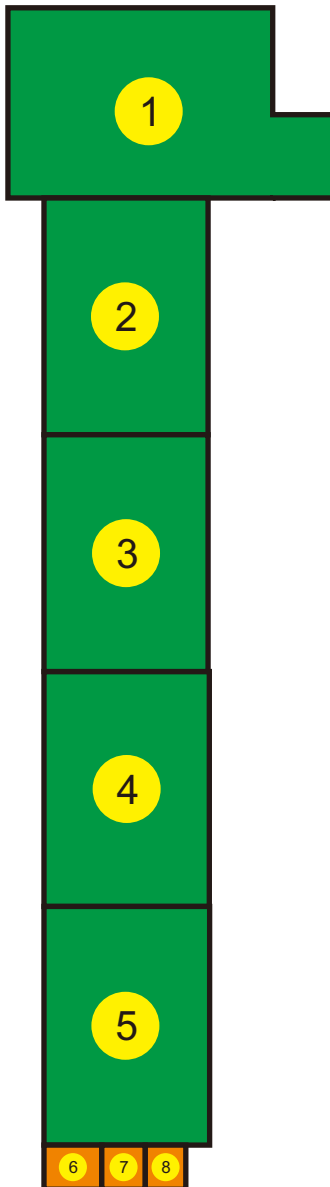

KETERANGAN

- | | |
|----------------------------|----------------------------|
| 1 B.24.01.01 MUSHOLA | 5 B.24.01.05 RUANG KELAS 1 |
| 2 B.24.01.02 RUANG KELAS 4 | 6 B.24.01.06 TOILET |
| 3 B.24.01.03 RUANG KELAS 3 | 7 B.24.01.07 TOILET |
| 4 B.24.01.04 RUANG KELAS 2 | 8 B.24.01.08 TOILET |

B.26 KAMPUS 3 JALAN BANTUL

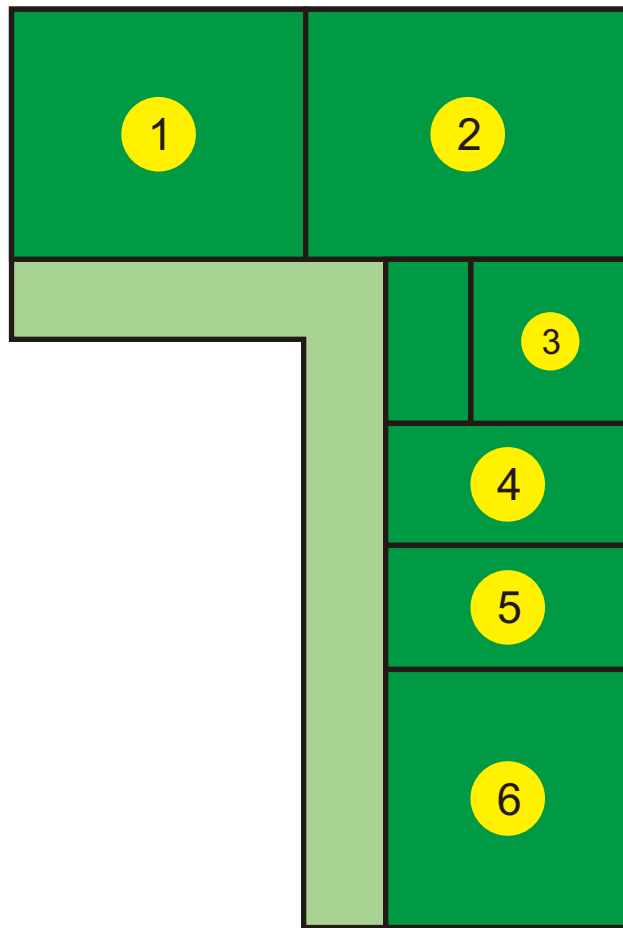

KETERANGAN

- | | |
|----------------------------|----------------------------|
| 1 B.26.1.1 RUANG KULIAH 59 | 4 B.26.1.4 RUANG KULIAH 57 |
| 2 B.26.1.2 RUANG KULIAH 58 | 5 B.26.1.5 RUANG KULIAH 56 |
| 3 B.26.1.3 RUANG MICRO | 6 B.26.1.6 RUANG KULIAH 55 |

B.29 KAMPUS 3 JALAN BANTUL

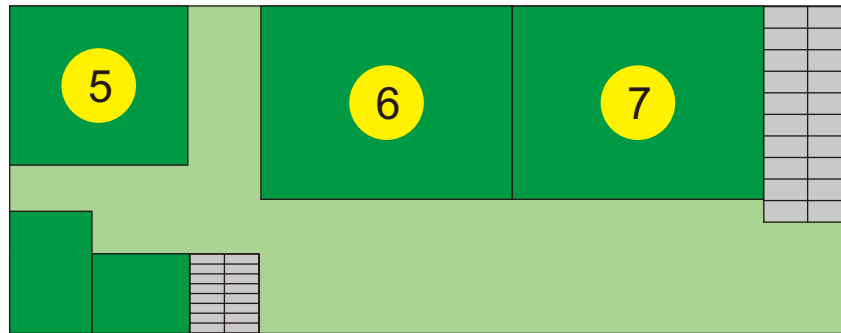

LANTAI 2

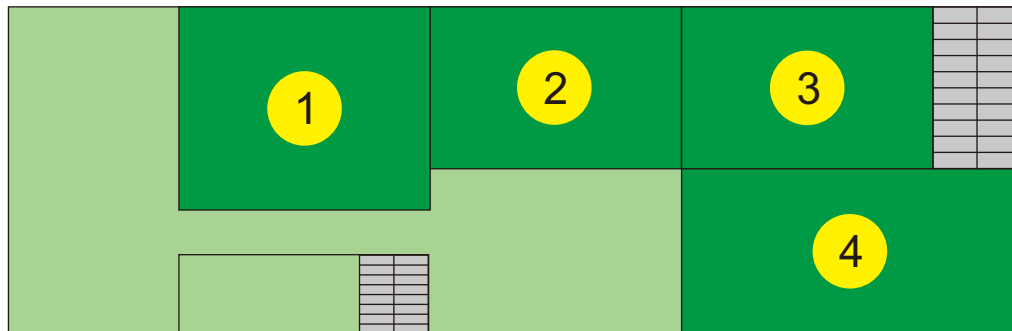

LANTAI 1

KETERANGAN

- 1 B.29.1.01 RUANG KELAS 60
- 2 B.29.1.02 RUANG KELAS 61
- 3 B.29.1.03 KANTOR
- 4 B.29.1.04 RUANG ADMINISTRASI
- 5 B.29.2.01 RUANG KELAS 63
- 6 B.29.2.02 RUANG SIDANG
- 7 B.29.2.01 RUANG KELAS 62

KAMPUS II JALAN KENARI

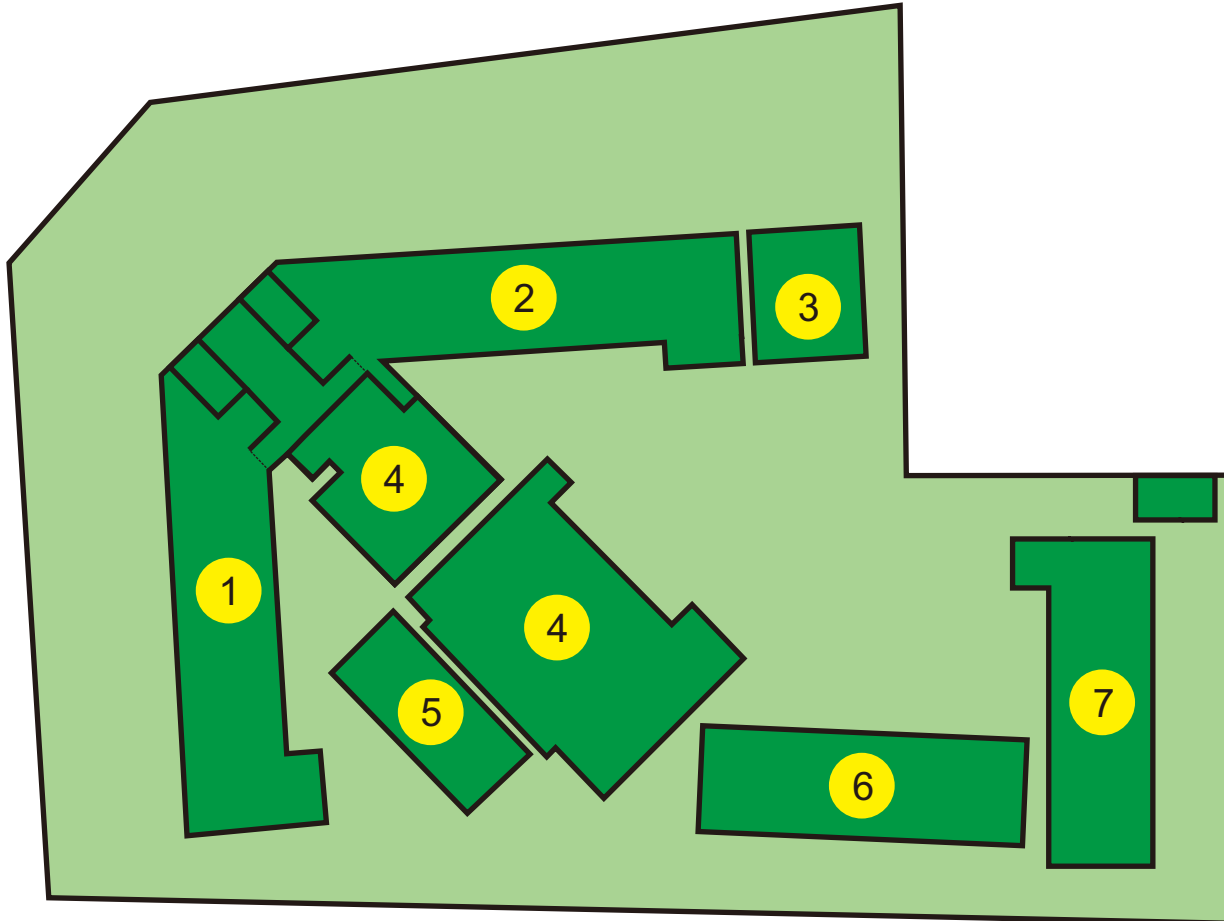

KETERANGAN

- 1 B.07 GEDUNG KULIAH 38-40
- 2 B.08 GEDUNG KULIAH 41-43
- 3 B.13 GEDUNG LAB IPA
- 4 B.11 GEDUNG AULA
- 5 B.10 GEDUNG KULIAH 42-43
- 6 B.12 GEDUNG KULIAH 44-45
- 7 B.09 GEDUNG KULIAH 48-50

B.08 GEDUNG KULIAH 41-43

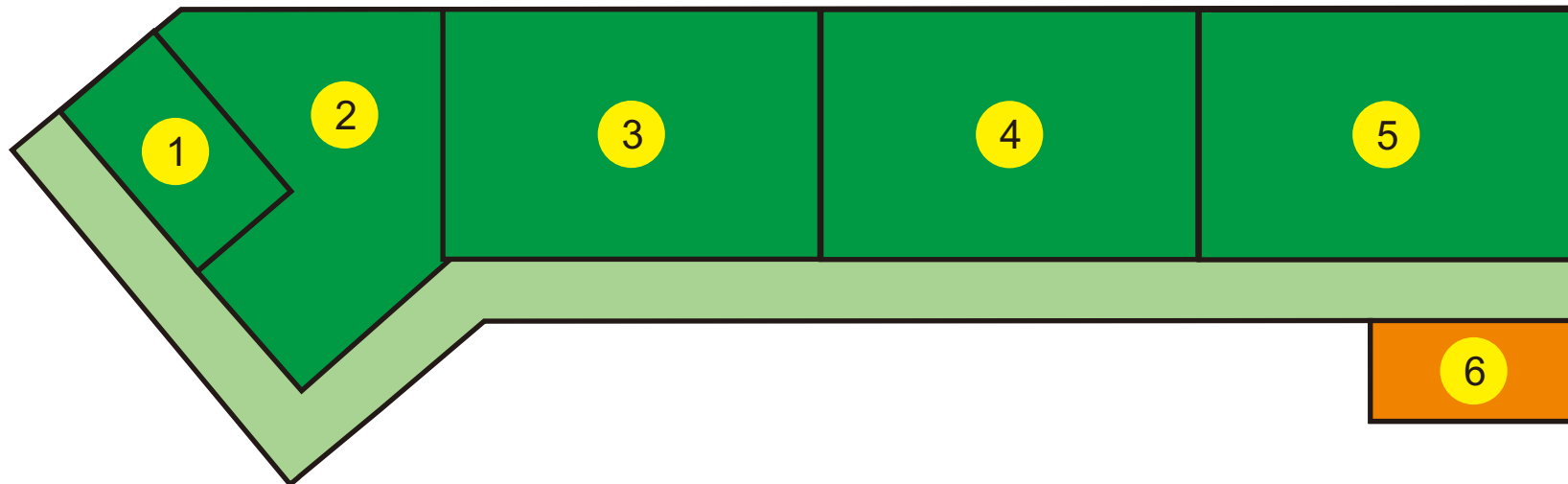

KETERANGAN

1 B.08.1.01 RUANG TAMU

2 B.08.1.02 RUANG DOSEN

3 B.08.1.04 RUANG KULIAH 41

4 B.08.1.05 RUANG KULIAH 42

5 B.08.1.06 RUANG KULIAH 43

6 B.08.1.03 TOILET

B.09 GEDUNG KULIAH & MUSHOLA

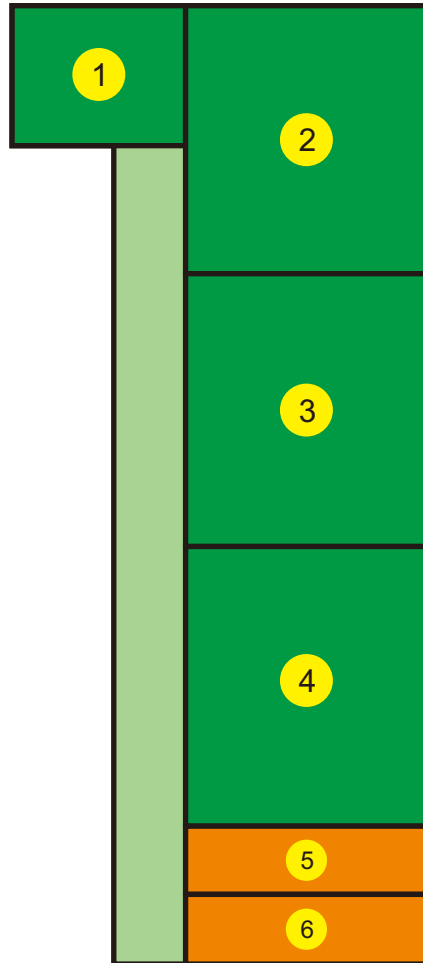

KETERANGAN

- 1 B.09.1.01 RUANG KMIP
- 2 B.09.1.04 RUANG KULIAH 48
- 3 B.09.1.05 RUANG KULIAH 49
- 4 B.09.1.06 RUANG KULIAH 50
- 5 B.09.1.02 TOILET
- 6 B.09.1.03 TOILET

B.07 GEDUNG KULIAH 38-40

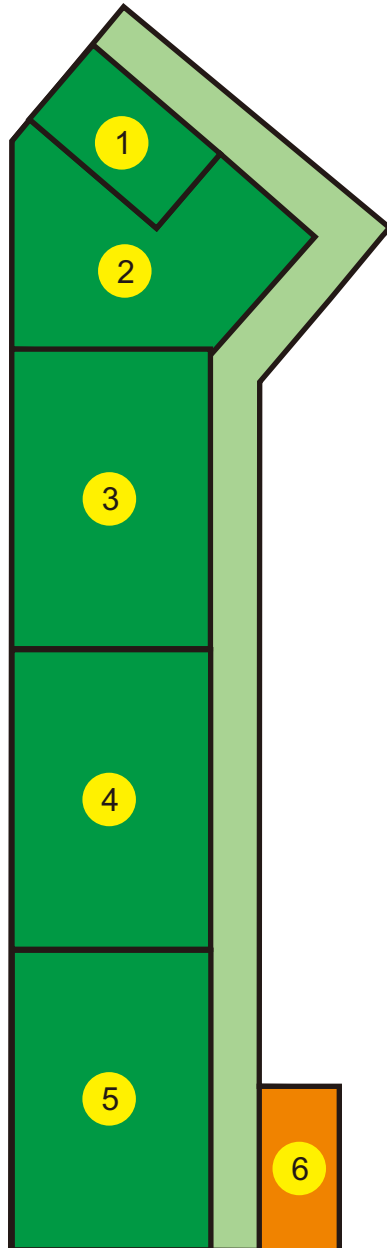

KETERANGAN

- | | |
|-----------------------------|-----------------------------|
| 1 B.07.1.01 UKMF REALITY | 4 B.07.1.04 RUANG KULIAH 39 |
| 2 B.07.1.02 HIMA PGSD | 5 B.07.1.05 RUANG KULIAH 40 |
| 3 B.07.1.03 RUANG KULIAH 38 | 6 B.07.1.06 TOILET |

B.11 AULA KAMPUS 2

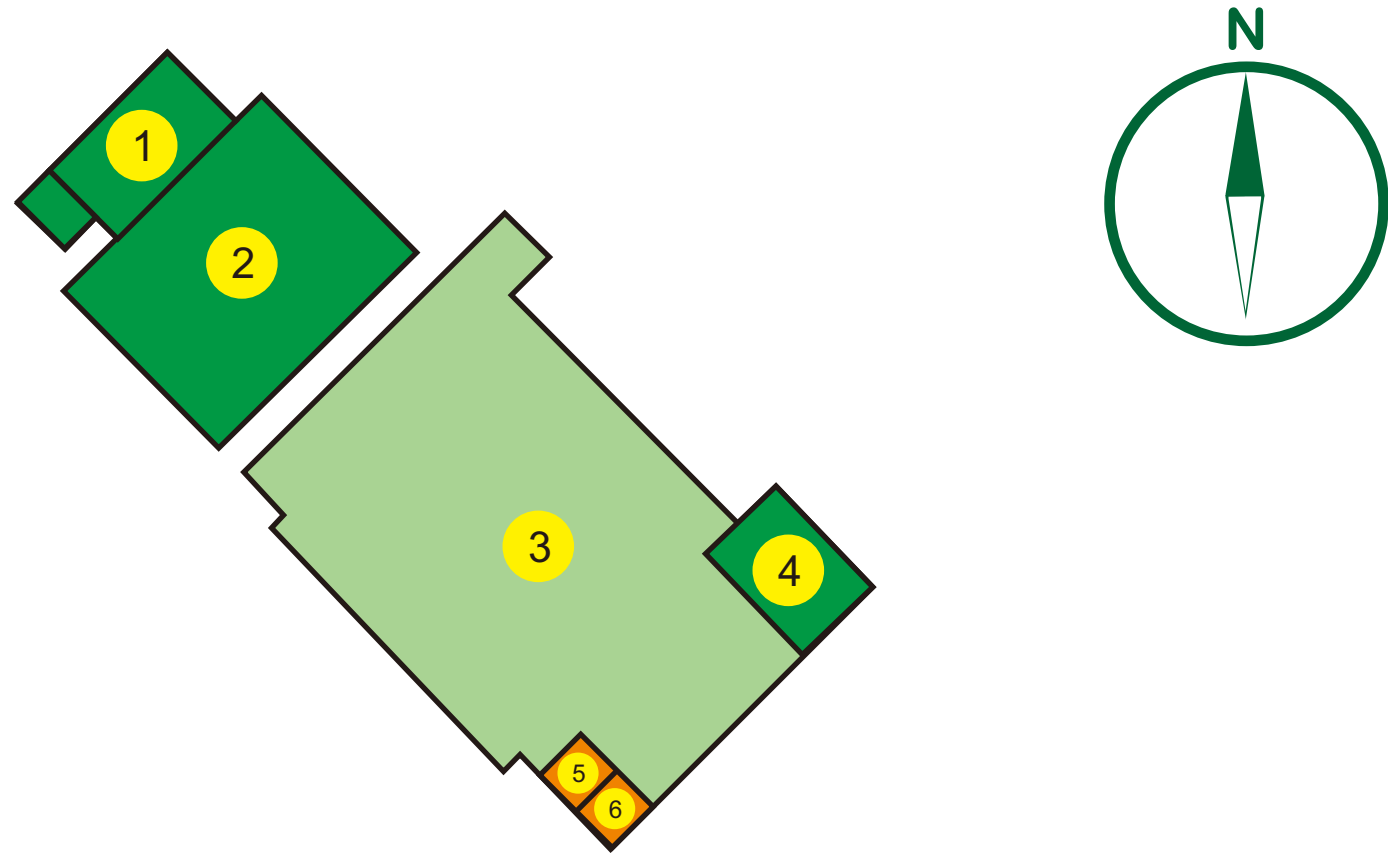

KETERANGAN

- | | |
|----------------------------|-----------------------------|
| 1 B.11.1.01 STUDENT SQUARE | 4 B.11.1.02 RUANG OPEERATOR |
| 2 B.11.1.03 RUANG KOMPUTER | 5 B.11.1.05 TOILET |
| 3 B.11.1.04 AULA | 6 B.11.1.06 TOILET |

B.10 GEDUNG KULIAH 42&43

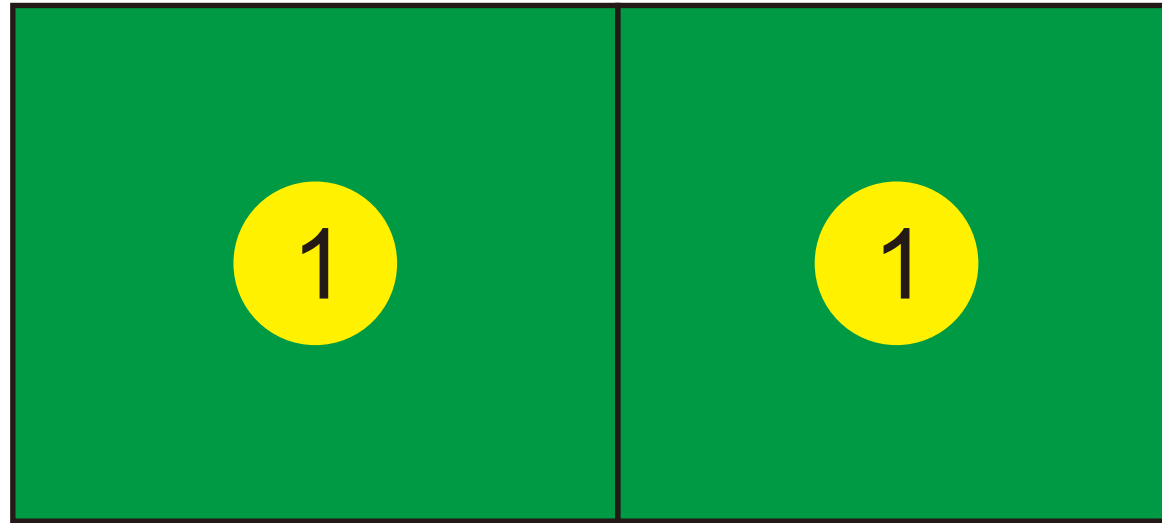

KETERANGAN

- 1 B.10.1.01 RUANG KULIAH 44
- 2 B.10.1.02 RUANG KULIAH 45

B.12 GEDUNG KULIAH & PERPUSTAKAAN

LANTAI 1

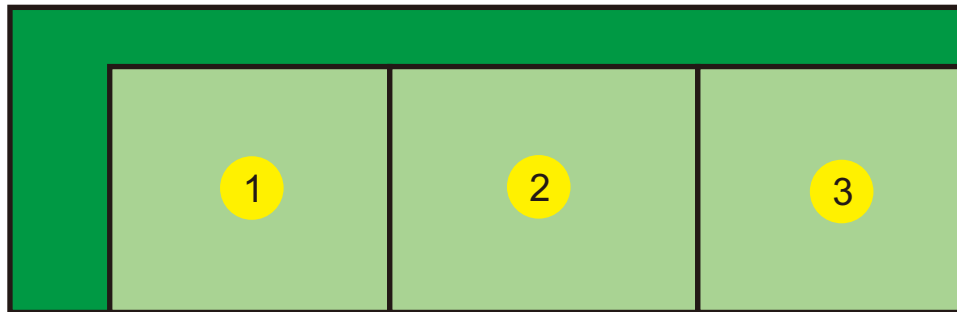

LANTAI 2

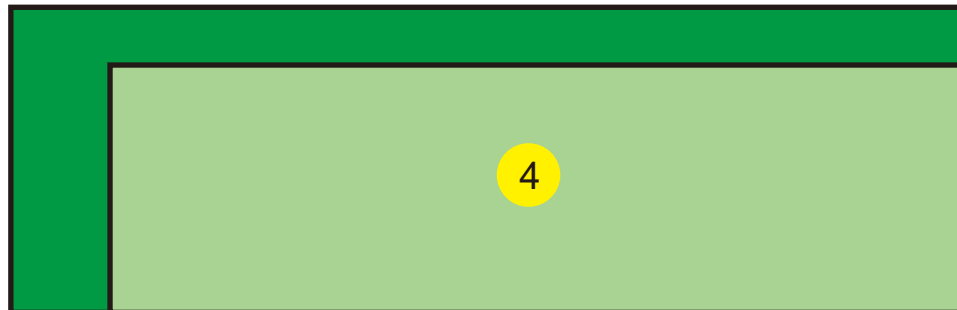

KETERANGAN

- 1 B.12.1.01 RUANG KULIAH 44
- 2 B.12.1.02 LAB MICROTEACHING
- 3 B.12.1.01 RUANG KULIAH 45
- 4 B.12.2.01 PERPUSTAKAAN



FAKULTAS ILMU PENDIDIKAN

PRASARANA

FAKULTAS ILMU PENDIDIKAN

SUBBAG UKBMN

DESEMBER 2021

